



# Middle Georgia Avenue/Petworth

## *Great Streets Improvements, Design Status Report*

*From Otis Place, N.W. to Webster Street, N.W.*



**District Department of Transportation  
Infrastructure Project Management Administration**

**March 10, 2009**



# Project Introduction



**Great Streets** is a multi-year and multiple agency effort to transform under-invested corridors into thriving and inviting neighborhood centers using public actions and resources, as needed, to leverage private investment in retail, housing, offices, and cultural facilities.



# Project Introduction



## For Middle Georgia Avenue:

- Alternative B of the Conceptual Design selected by the community.
- Approximately 0.7 mile long project area
- Roadway and streetscape improvements
- Park and plaza landscaping
- Improvements:
  - trees, streetlights, curbs & gutters, sidewalks, signals, pedestrian crossings, catch basins, hydrants
- Site furnishings and signage
- Seven redevelopment areas
- Low impact development opportunities
- 9<sup>th</sup> Street from Georgia Avenue to Kansas Avenue Improvements
- Upshur Street from Georgia Avenue to 8<sup>th</sup> Street Improvements





# Existing Cross-Section

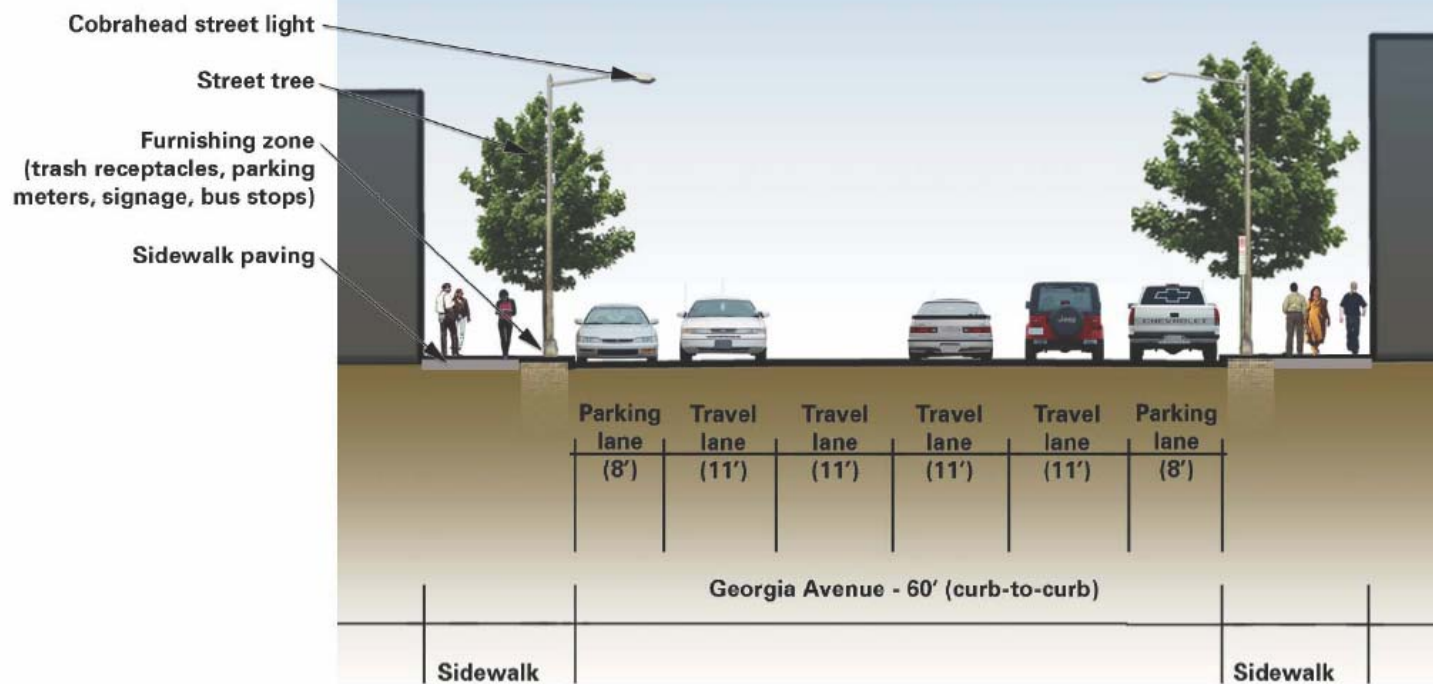

TYPICAL SECTION: EXISTING CONDITIONS



# Proposed Cross-Section



New teardrop light at intersections

New twin-20, pedestrian scale light

New trees (primarily infill)

Furnishing zone  
(trash receptacles, consolidated  
parking meters, signage, bus  
stops, bike racks)

New sidewalk paving

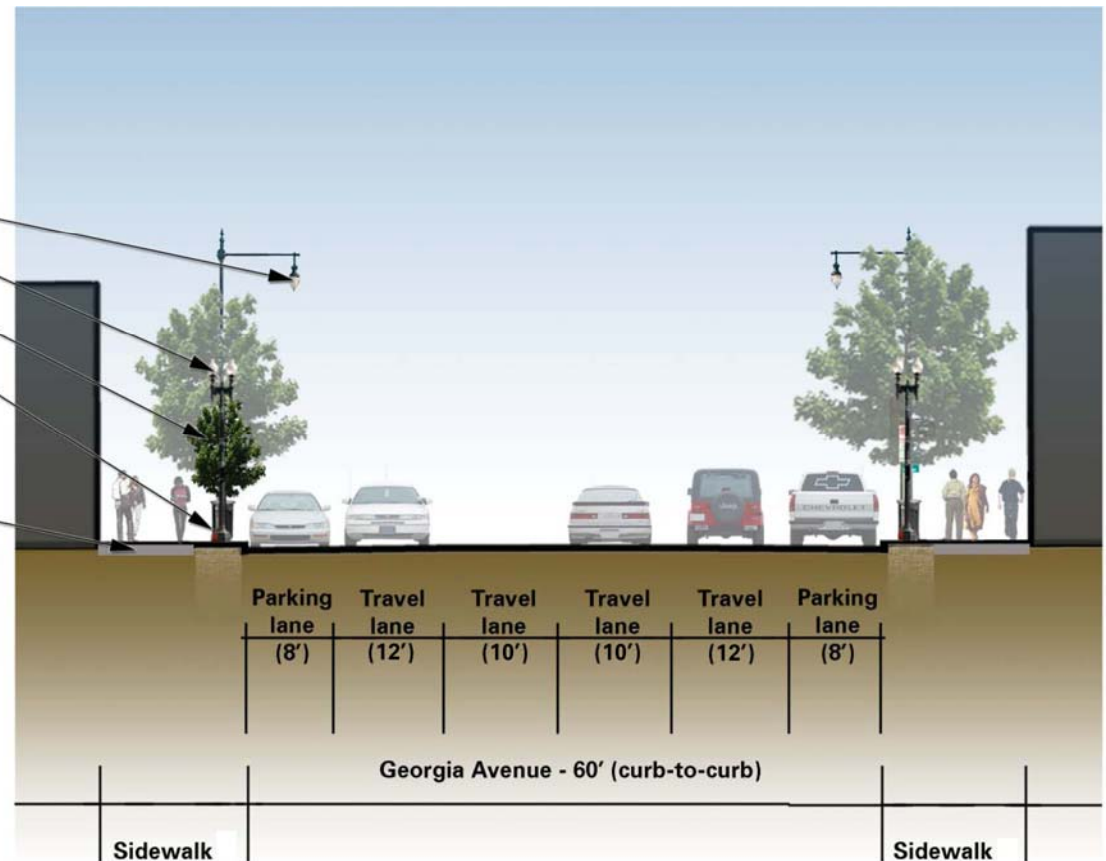

TYPICAL SECTION: PROPOSED

PREFERRED ALTERNATIVE 35



d.

DISTRICT DEPARTMENT OF TRANSPORTATION

PSI Team

# Landscape Design – Metro Node

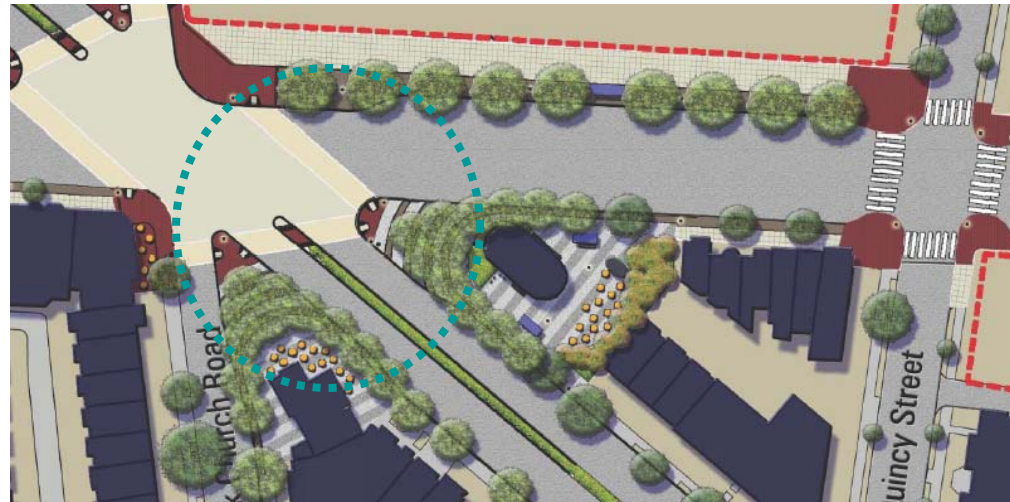

EXISTING CONDITIONS



PREFERRED ALTERNATIVE



# Landscape Design – Park Node



EXISTING CONDITIONS



PREFERRED ALTERNATIVE



# Progress Report



- Notice-To-Proceed – *Jul 18, 2008*
- 30% Design Submittal – *Oct 22, 2008*  
*Two weeks review*
- 65% Design Submittal – *Jan 30, 2009*  
*Two weeks review*
- Final Package and Bid Documents Submittal – *May, 2009*





**d.**

DISTRICT DEPARTMENT OF TRANSPORTATION

*PSI Team*

# Design Plans



Middle Georgia  
Avenue/Petworth

Great Streets  
Improvements



d.

DISTRICT DEPARTMENT OF TRANSPORTATION

PSI Team

# Design Plans



Middle Georgia  
Avenue/Petworth

Great Streets  
Improvements



d.

DISTRICT DEPARTMENT OF TRANSPORTATION

PSI Team

# Design Plans







# Design Plans

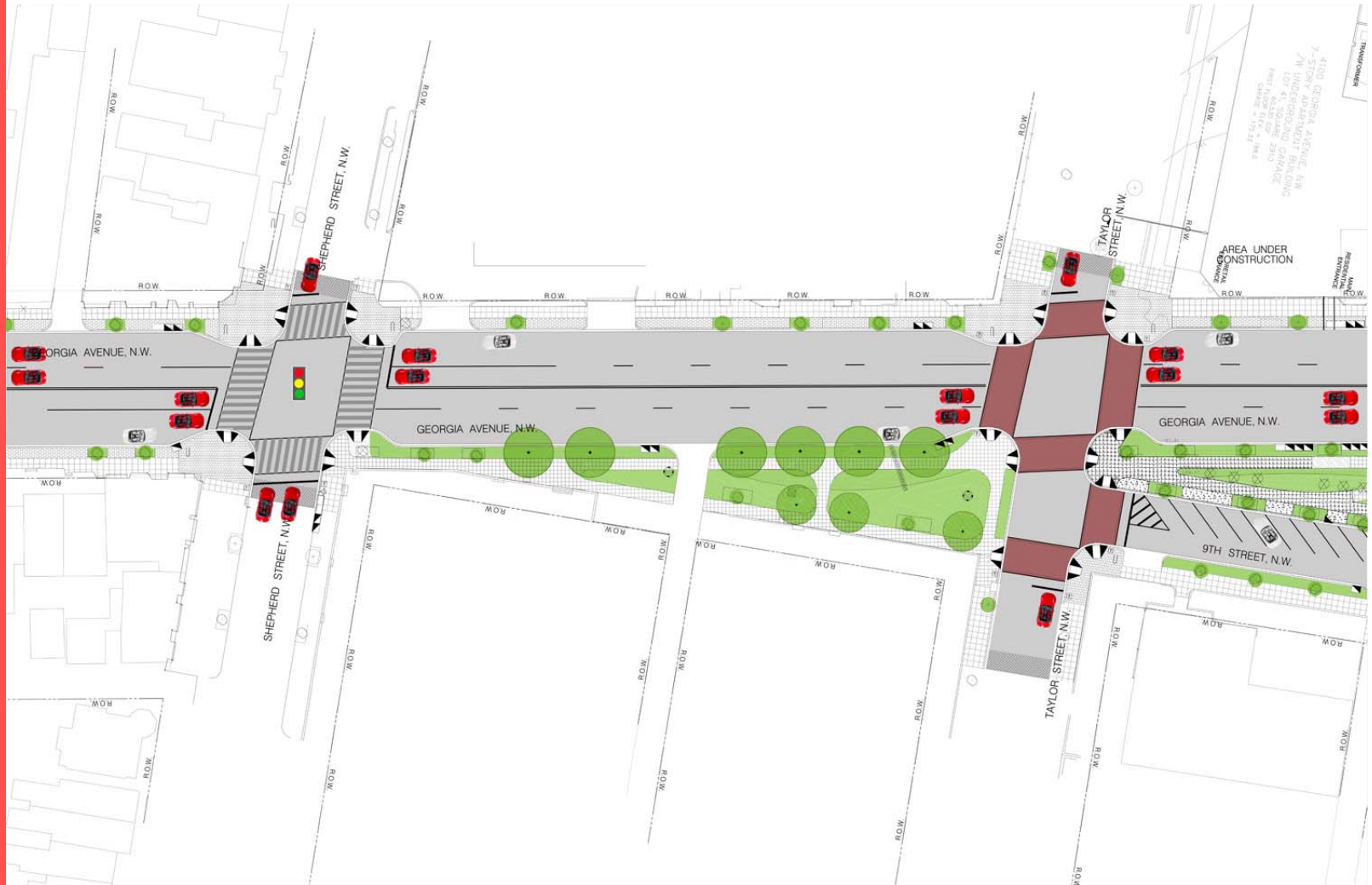

Middle Georgia  
Avenue/Petworth

Great Streets  
Improvements



d.

DISTRICT DEPARTMENT OF TRANSPORTATION

PSI Team

# Design Plans





d.

DISTRICT DEPARTMENT OF TRANSPORTATION

PSI Team

# Design Plans





Middle Georgia  
Avenue/Petworth

*Great Streets  
Improvements*



*PSI Team*

# Design Plans





Thank you!

Questions?