

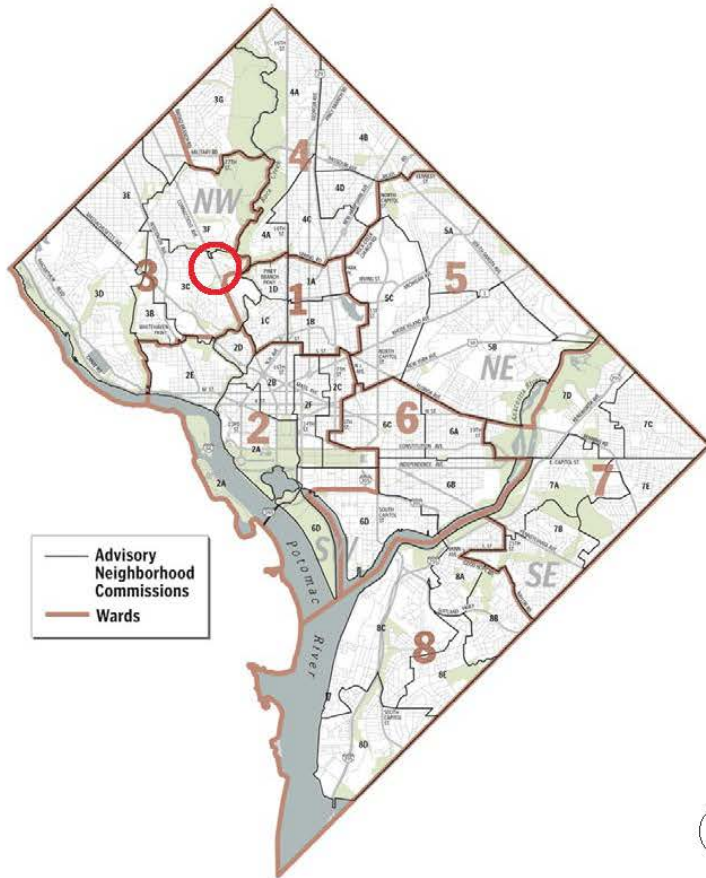

CLEVELAND PARK STREETScape AND DRAINAGE IMPROVEMENTS

Urban Context



Washington, D.C.

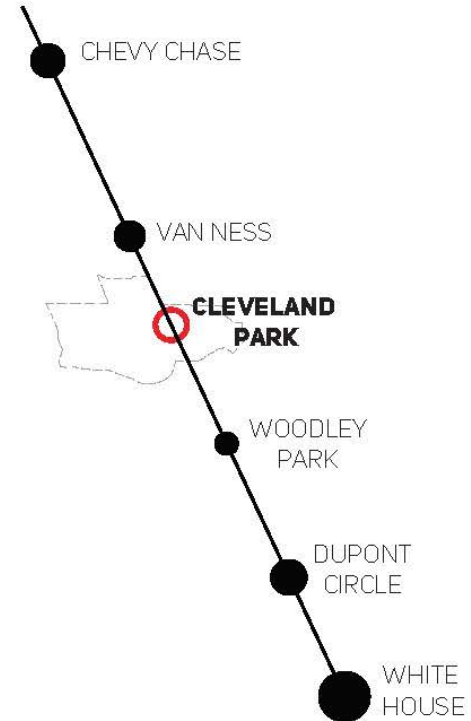

Connecticut Avenue

Neighborhood Context



PROJECT AREA



Contributing Drainage Areas

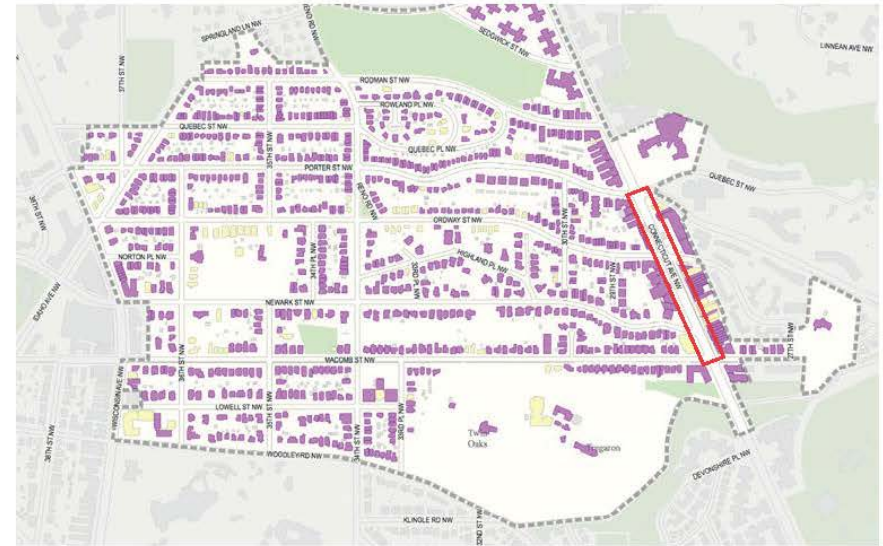

PROJECT AREA CONTRIBUTING BUILDING NON-CONTRIBUTING

Cleveland Park Historic District

Cleveland Park - A diminished streetscape

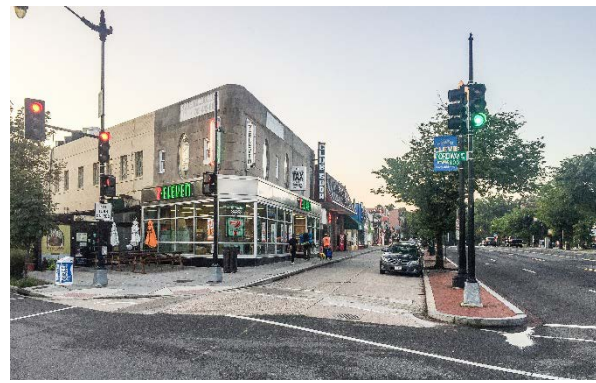
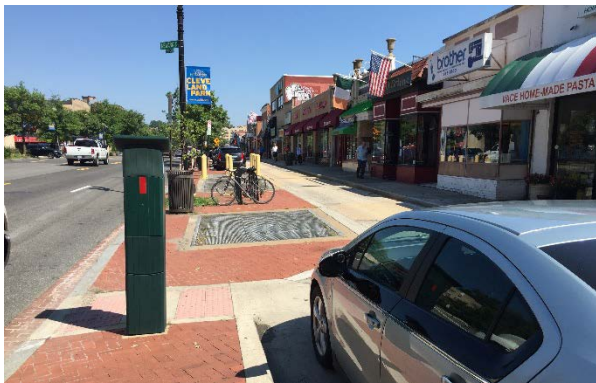

The goal is to recreate a vibrant public realm.

Elevate

Delineate

Create

Concept Strategies

Elevate the pedestrian experience.

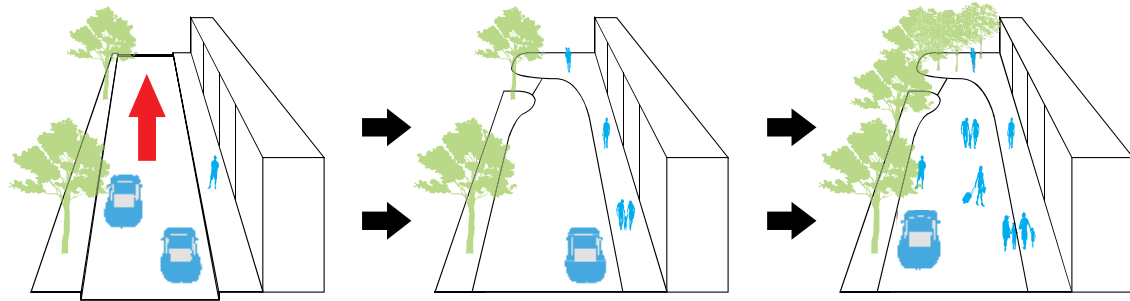

Delineate clearly defined flexible zones in the public space.

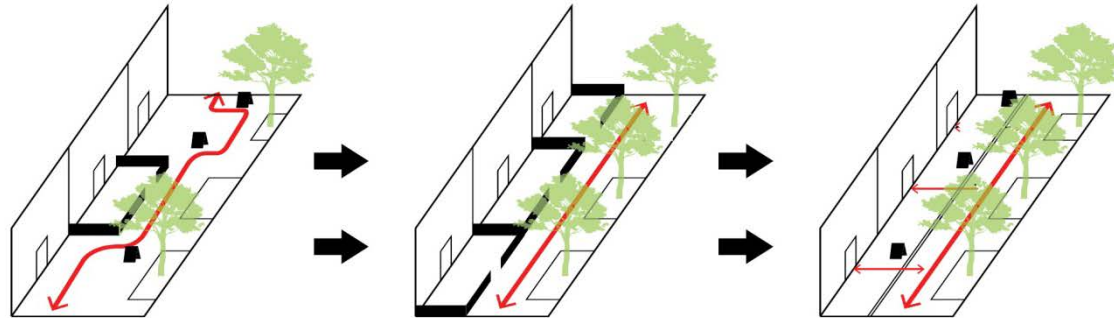

Create spaces that will make Cleveland Park a destination.

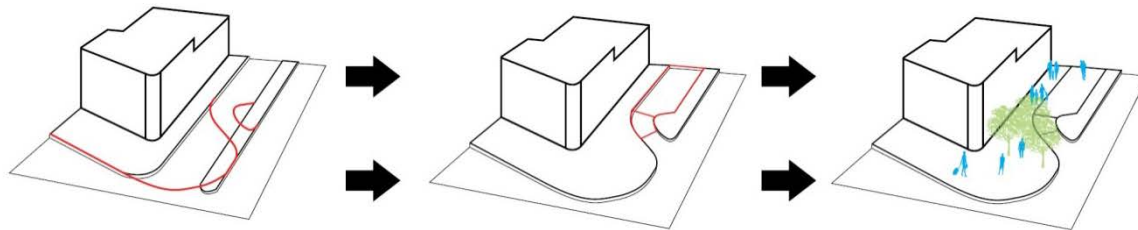

Public Outreach

Public Meeting #1
September 15, 2016



Public Meeting #2
June 8, 2017



Streetscape Committee
August 1, 2017



Streetscape Committee
August 29, 2017



A significant change in Cleveland Park

Raise the service lane and ensure user safety

Behavior Indicators integrated into the streetscape.

1. Incorporate different paving materials, colors, and textures to orient and alert pedestrians – as well as motorists.
2. Buffer sidewalks with streetscape elements to ensure pedestrian comfort and confidence.
3. Create gathering areas for seating and congregate.

Raising the Service Lane

Shared-use Space vs. Shared Surface

Concern: Eliminating a traditional safety barrier – the raised curb.



Examples of Shared Surface

Amsterdam, Netherlands

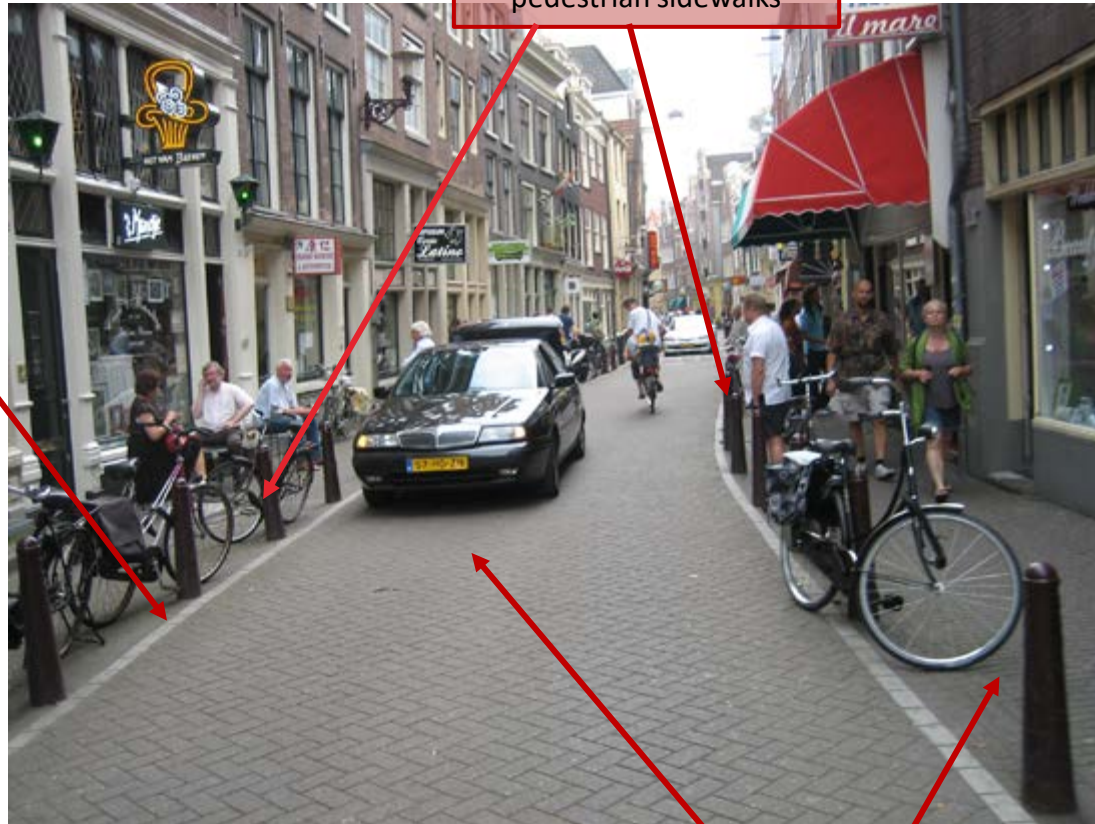

Bollards as buffering elements to create a safe pedestrian sidewalks

Different color banding to warn pedestrians of potential conflict.

Different paving patterns to visually separate the two areas.

Examples of Shared-use Spaces

Bonn, Germany

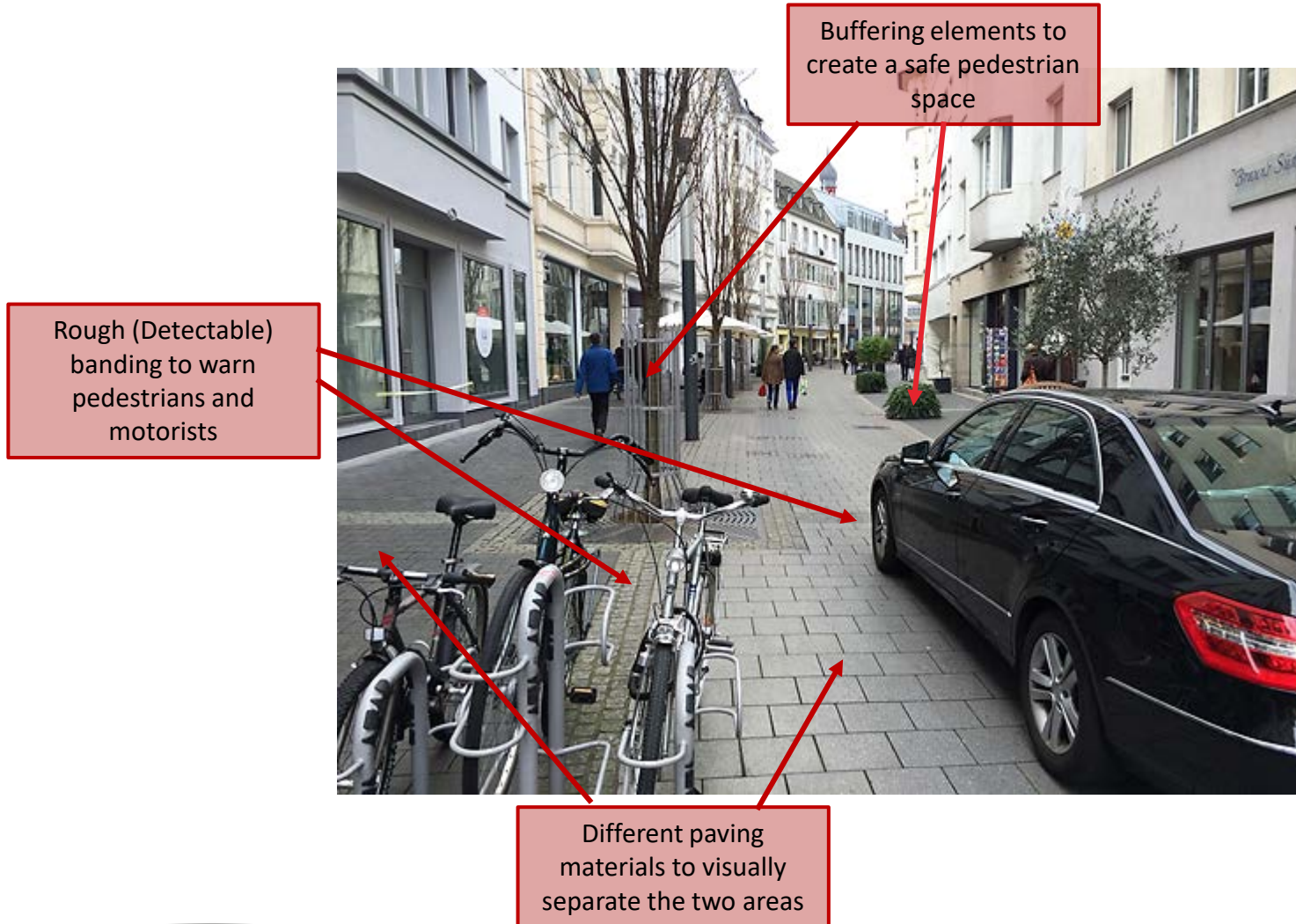

Existing Conditions



Tree Planting Zone.
Safe pedestrian area
for furnishings. Porous
Rubber sidewalk to
expand soil volume

“Shared-use Area”
Space for vehicular
travel lane, as well as a
pedestrian area.

Buffered Sidewalk
“Pedestrian-only Zone”

“Shared-use Area”
Midblock crossing

“Shared-use Area”
Space for vehicular
parking lane, as well as
a pedestrian area.

Existing Conditions

Vehicular Movement

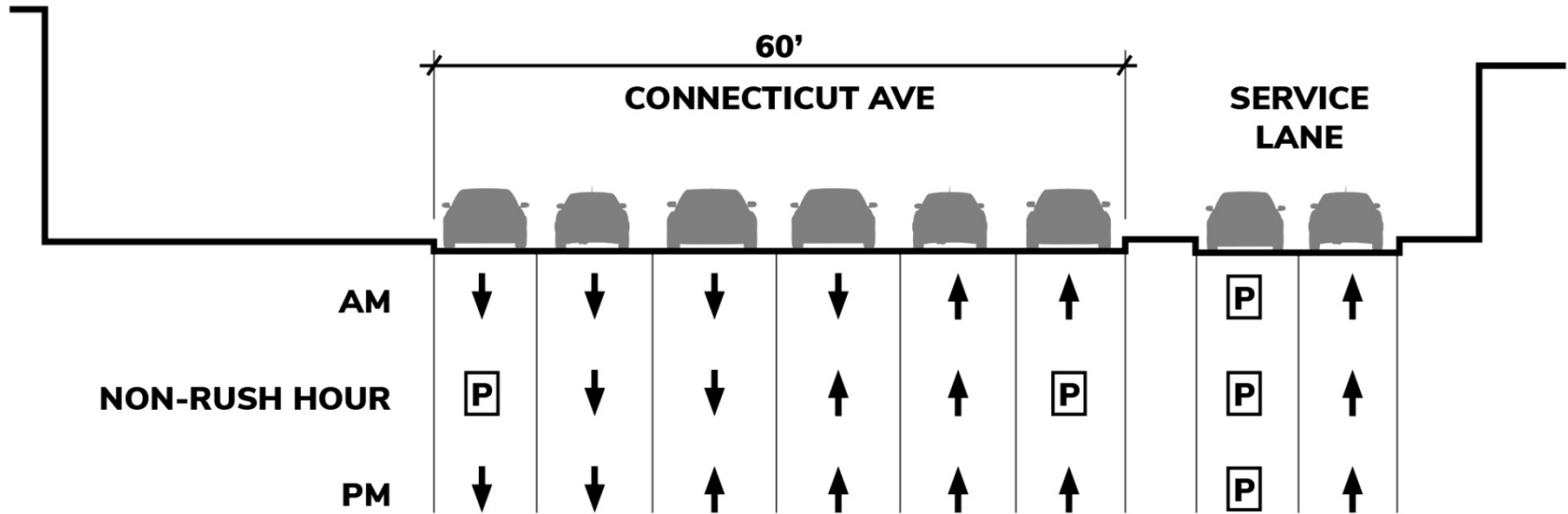

Existing Conditions



Proposed Design



Behavior Indicators: Pavements

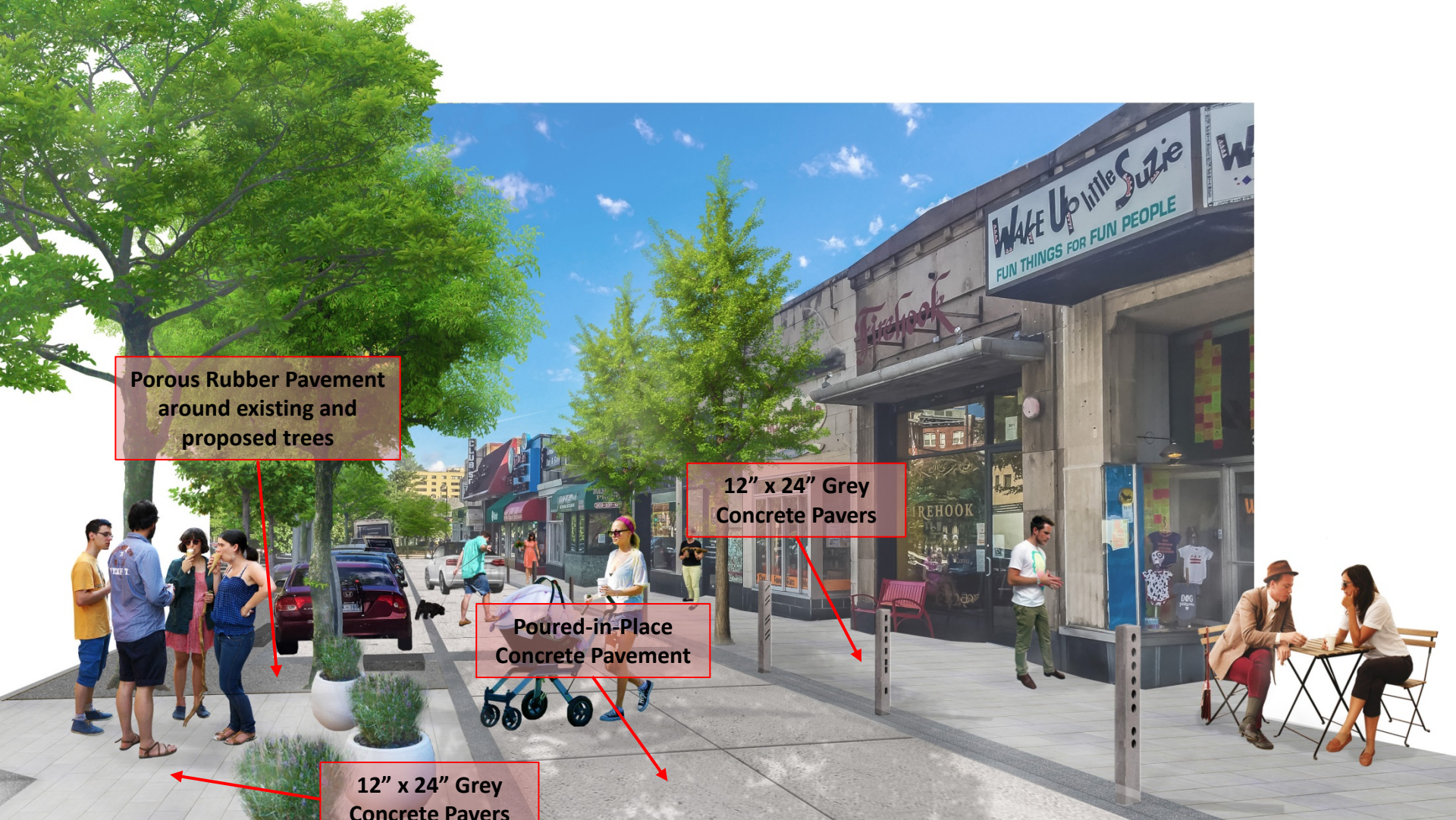

Porous Rubber Pavement
around existing and
proposed trees

12" x 24" Grey
Concrete Pavers

Poured-in-Place
Concrete Pavement

12" x 24" Grey
Concrete Pavers

Behavior Indicators: Buffering

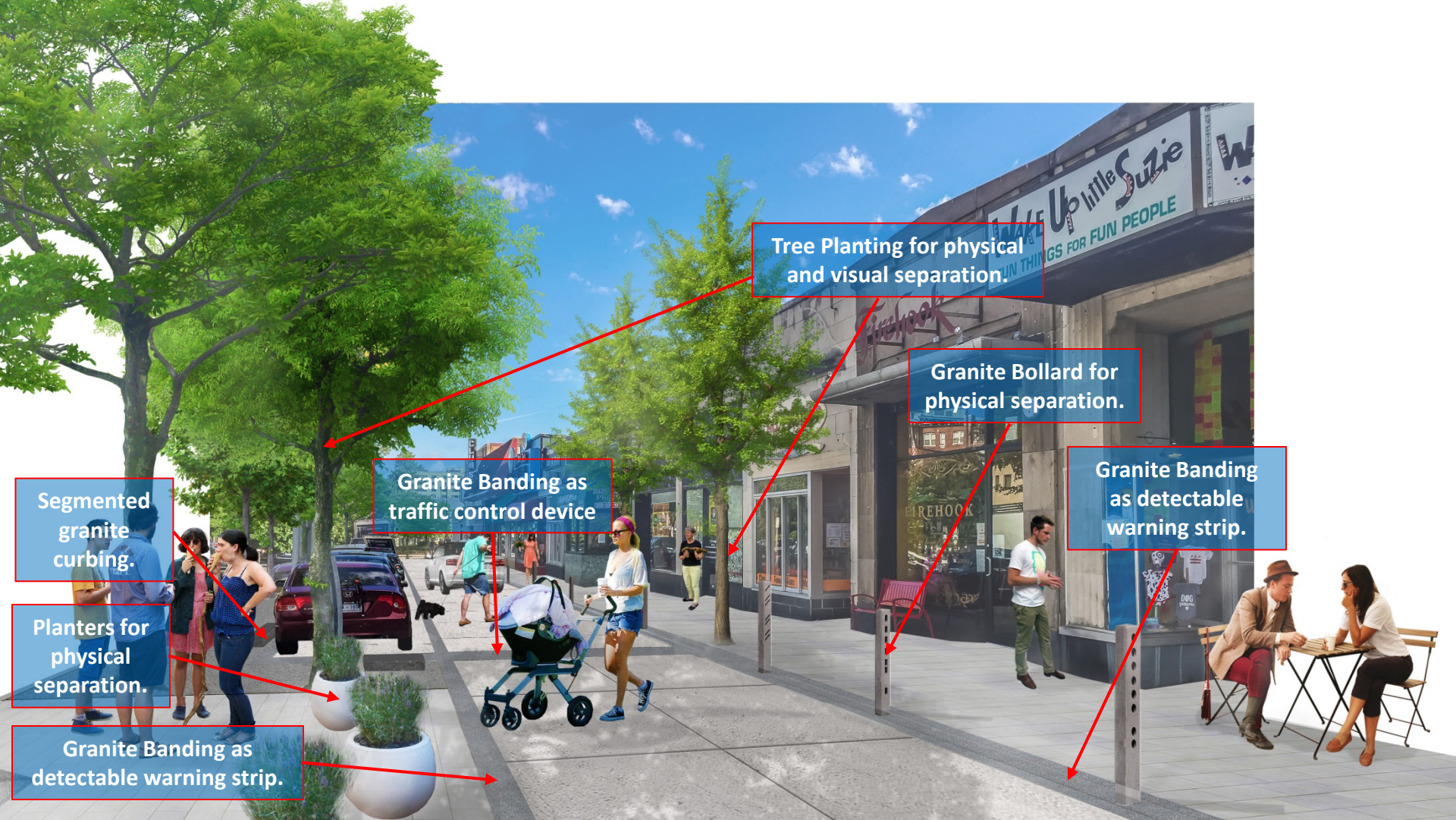

Segmented granite curbing.

Planters for physical separation.

Granite Banding as detectable warning strip.

Granite Banding as traffic control device

Tree Planting for physical and visual separation.

Granite Bollard for physical separation.

Granite Banding as detectable warning strip.

Behavior Indicators: Gathering Areas



The Shared-use Area

Existing Conditions

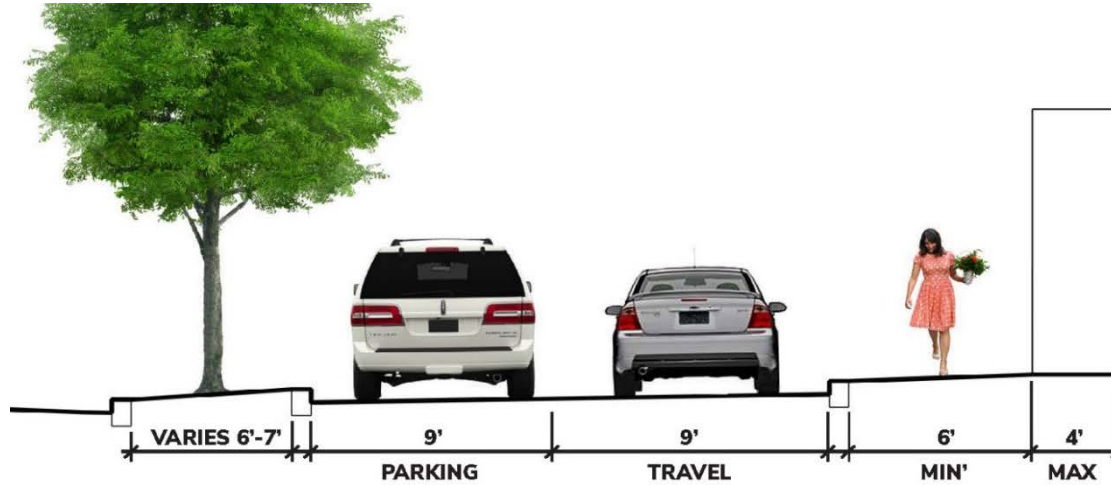

Proposed Shared-use Area

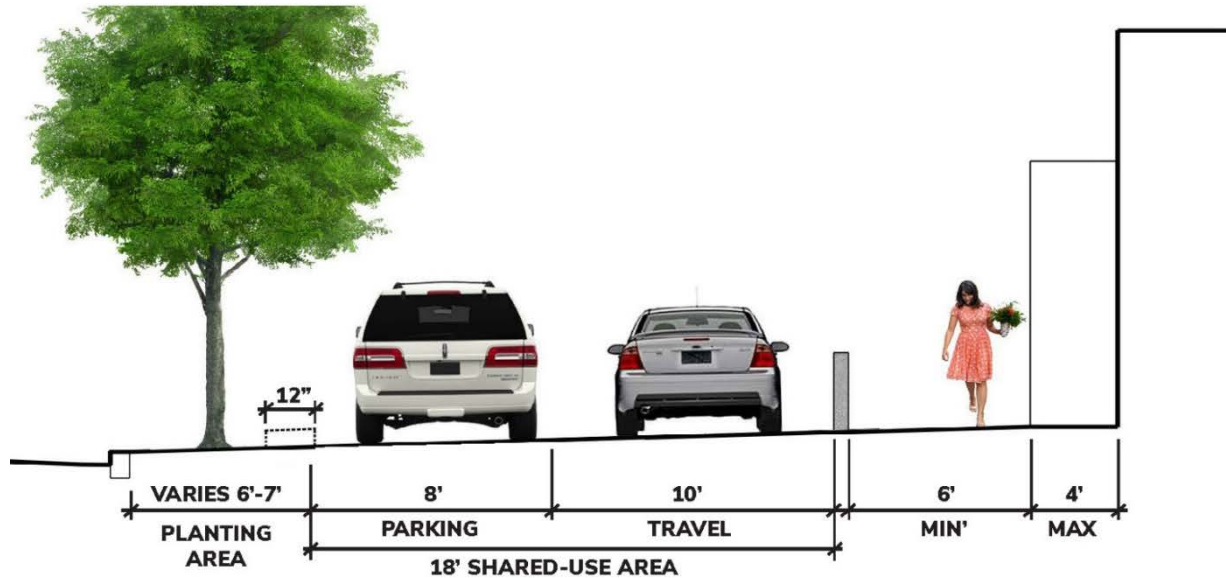

The Shared-use Area

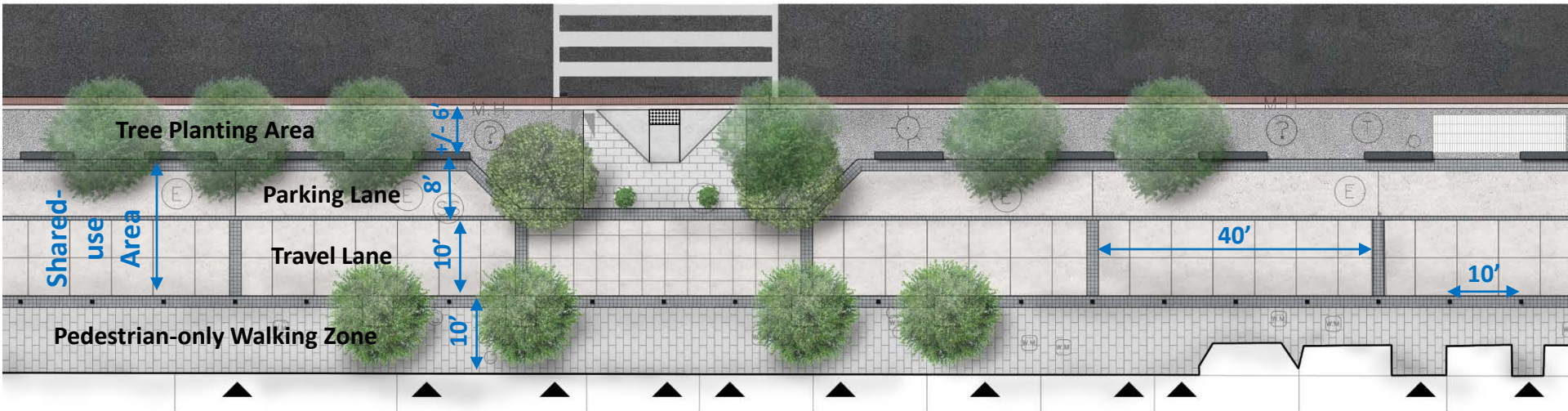

Site Plan

The Shared-use Area's design palette influences the rest of Cleveland Park's Streetscape Design



- + Standardized tree pit edging
- + Orderly planting beds
- + Uniform 18" Granite banding
- + Organized spatial layout



- + Increased seating areas
- + High-albedo material palette
- + Increased tree canopy coverage
- + Enhanced pedestrian experience



- + Creation of gathering areas
- + Upgraded ADA feature
- + Variety of seating options
- + Improved pedestrian circulation



- + Implementation of public art
- + Increased public space
- + Uniform material palette
- + Improved user safety

Gateways and Urban Nodes

Public Art



Functional



Sculptural



Natural

Entrance into Share-use area

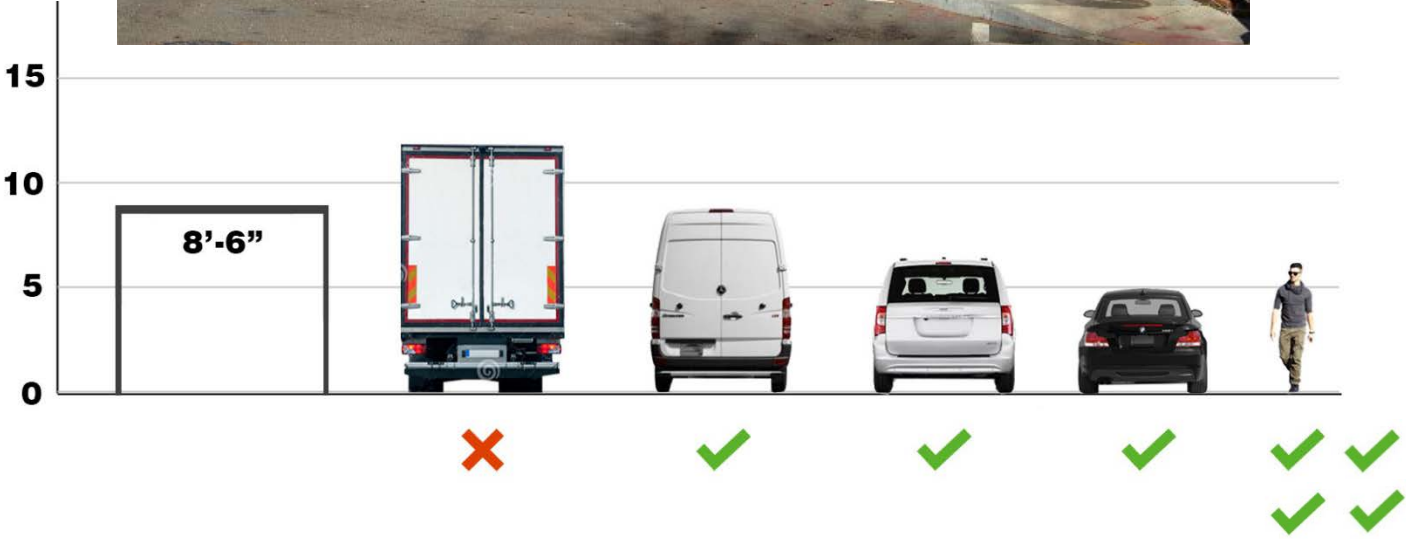

Ordway Plaza and the Metro area

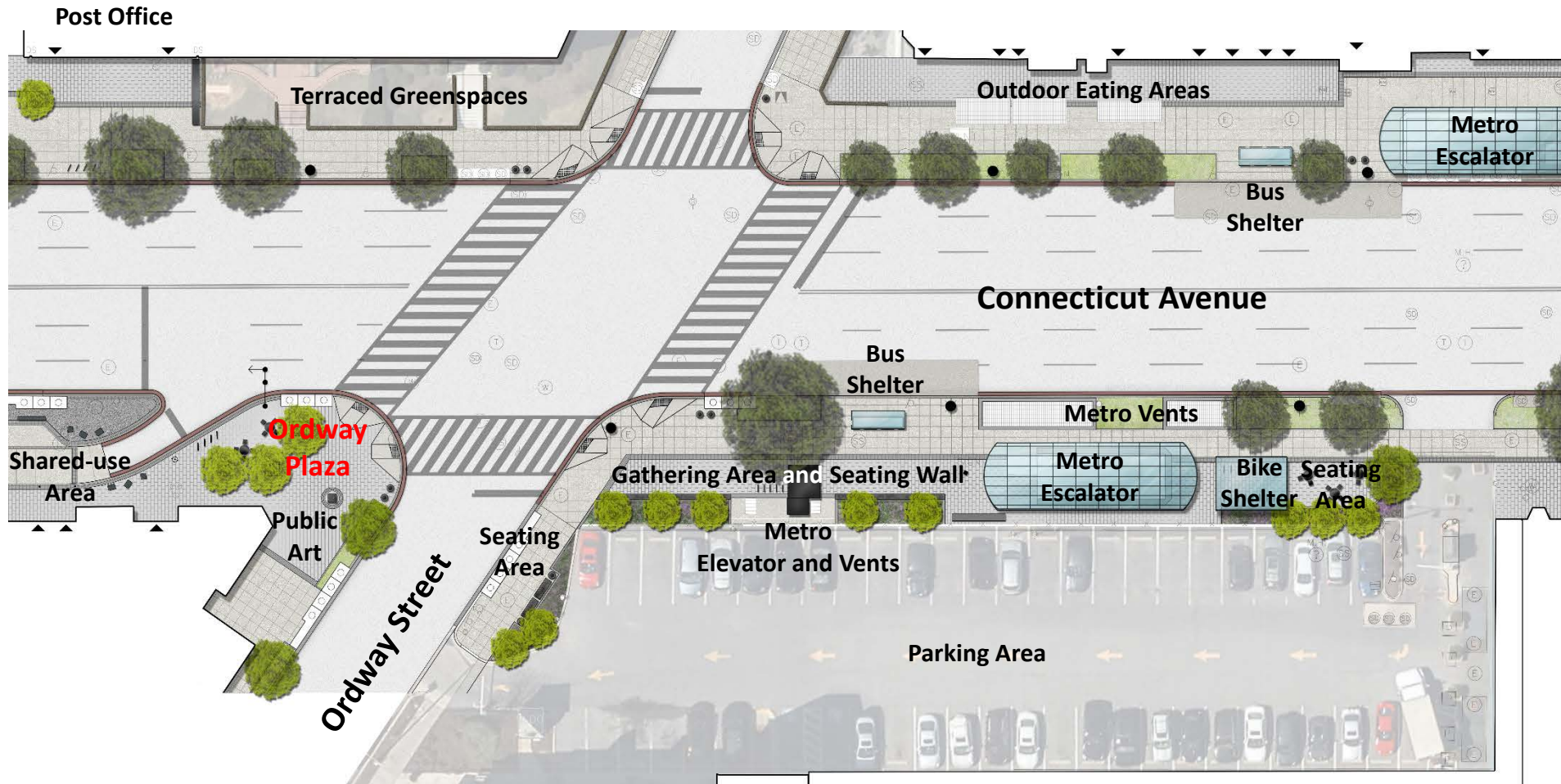

Existing Condition at Service Lane Exit



Ordway Plaza



Public Realm at Uptown Theater

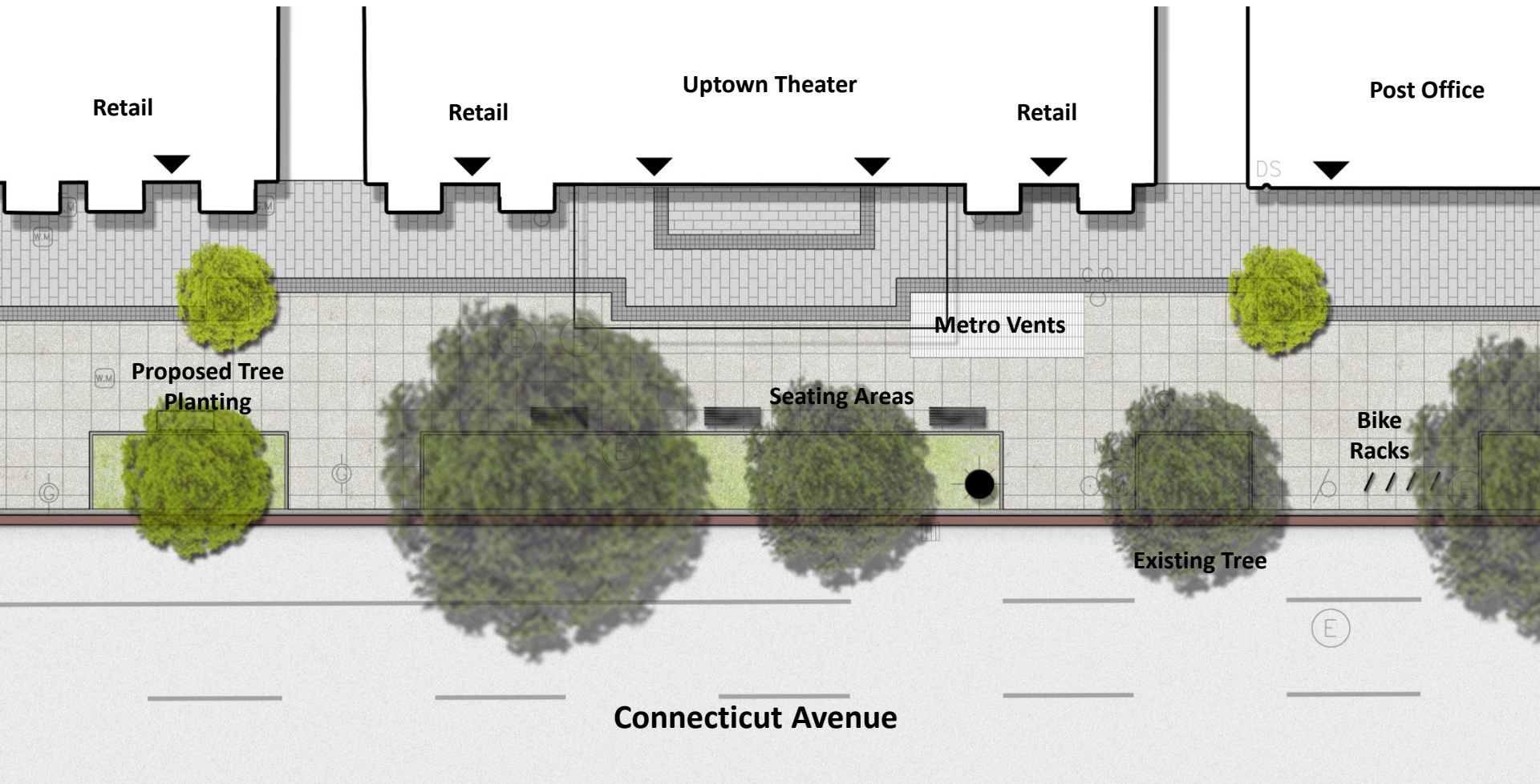

Public Realm at Uptown Theater

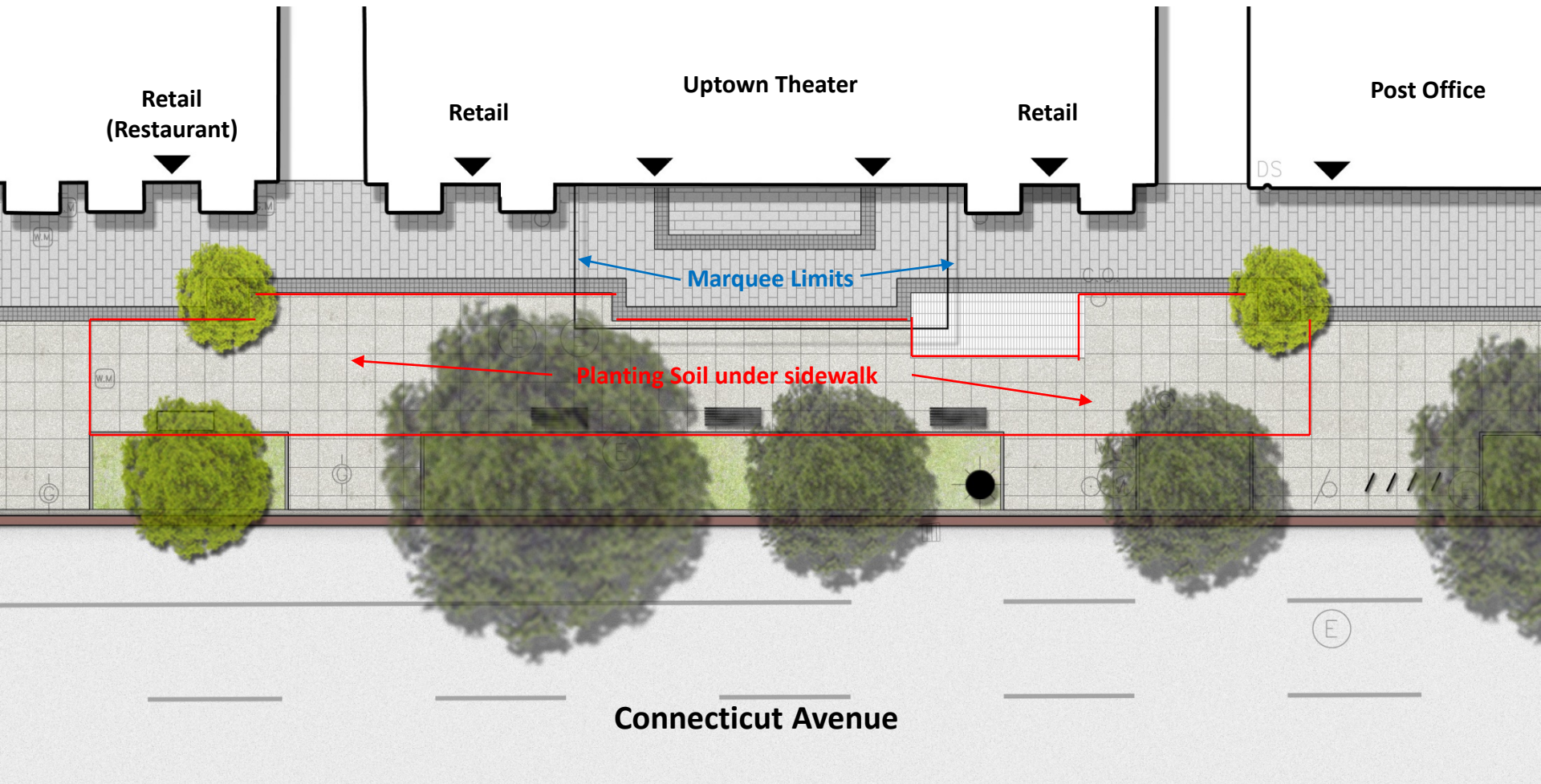

Increase Planting Volume for Street Trees

MEDIUM TREE
VOLUME REQUIREMENTS:
1,000 CUBIC FEET

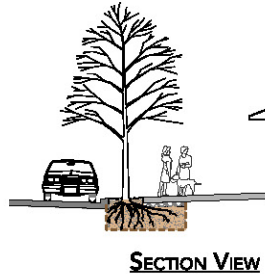
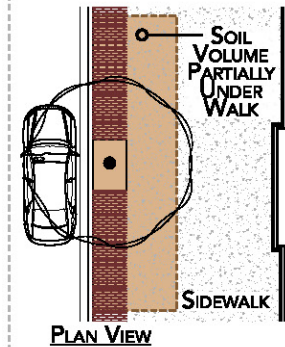

LARGE TREE
VOLUME REQUIREMENTS:
1,500 CUBIC FEET

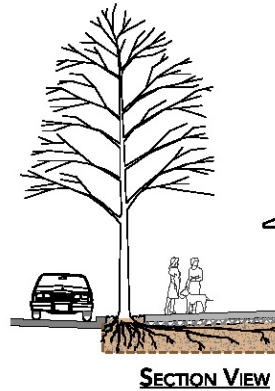
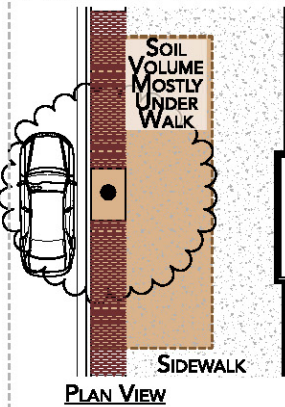

image courtesy of Greening DC Streets - DDOT

porosity of the pavement should increase the success of existing and proposed trees.

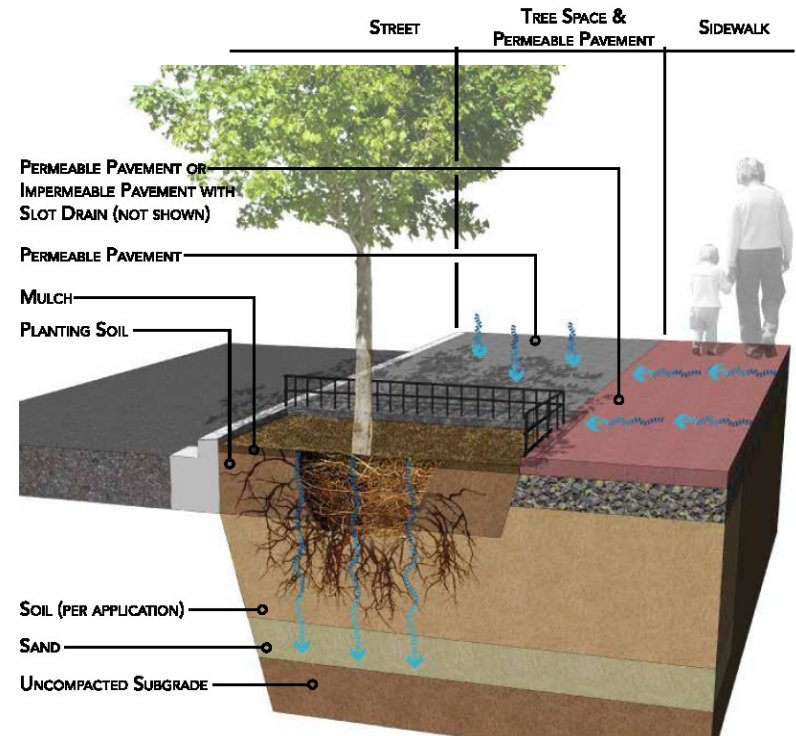
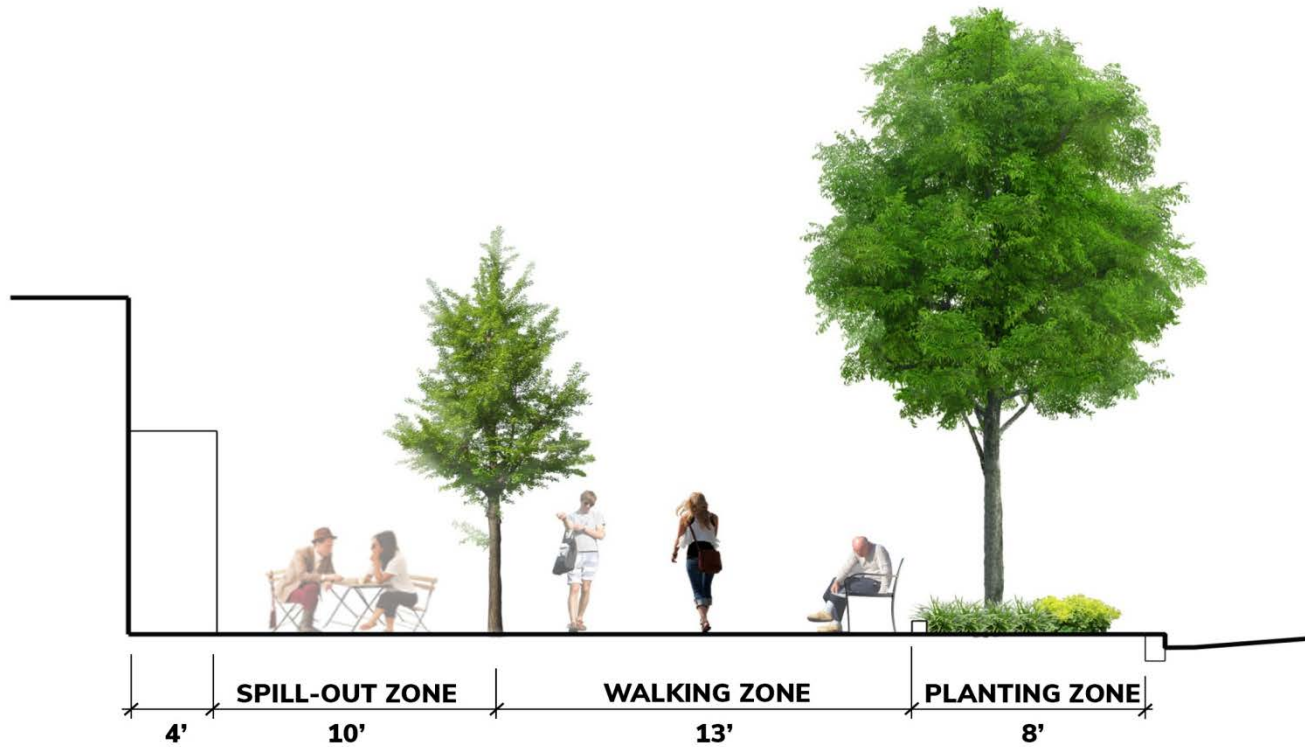

image courtesy of Greening DC Streets - DDOT

Public Realm at Uptown Theater



Public Realm at Uptown Theater



Public Realm at Uptown Theater



Public Realm near Fire Station

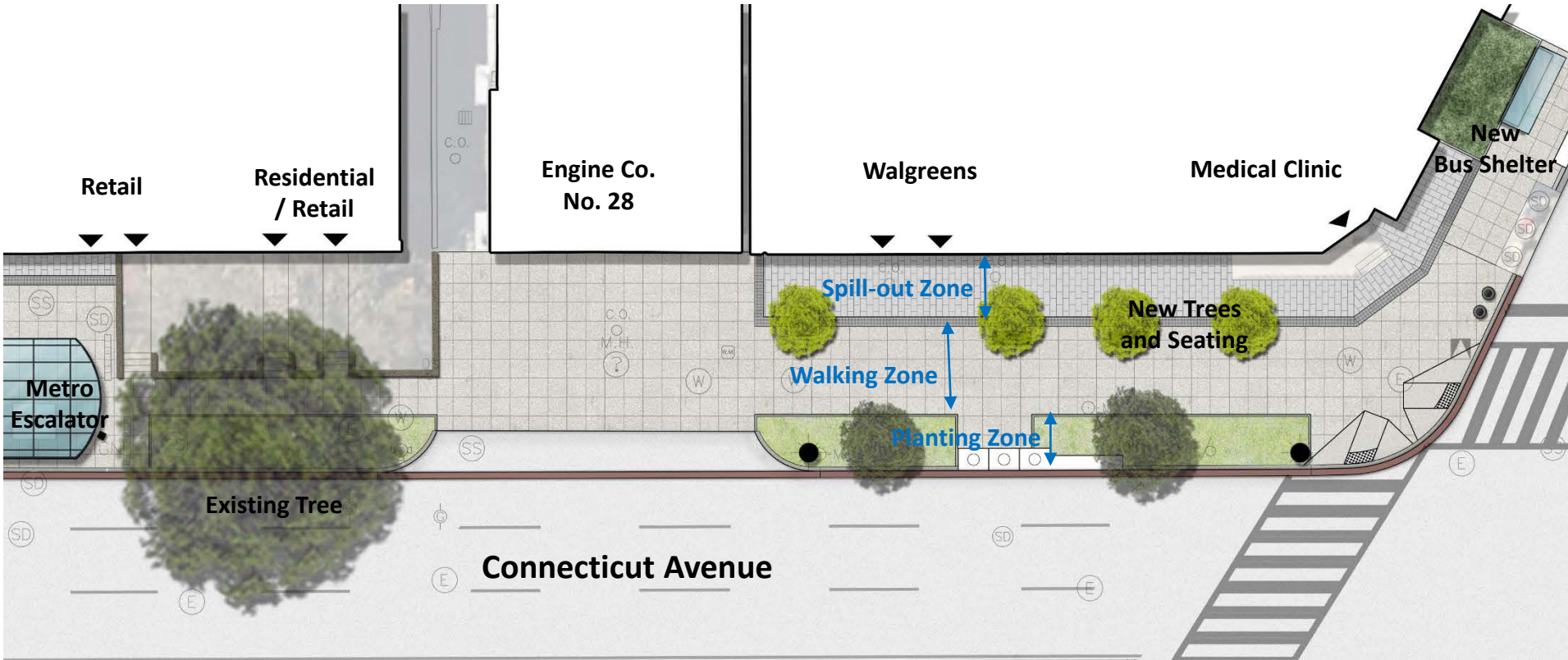

Public Realm near Fire Station

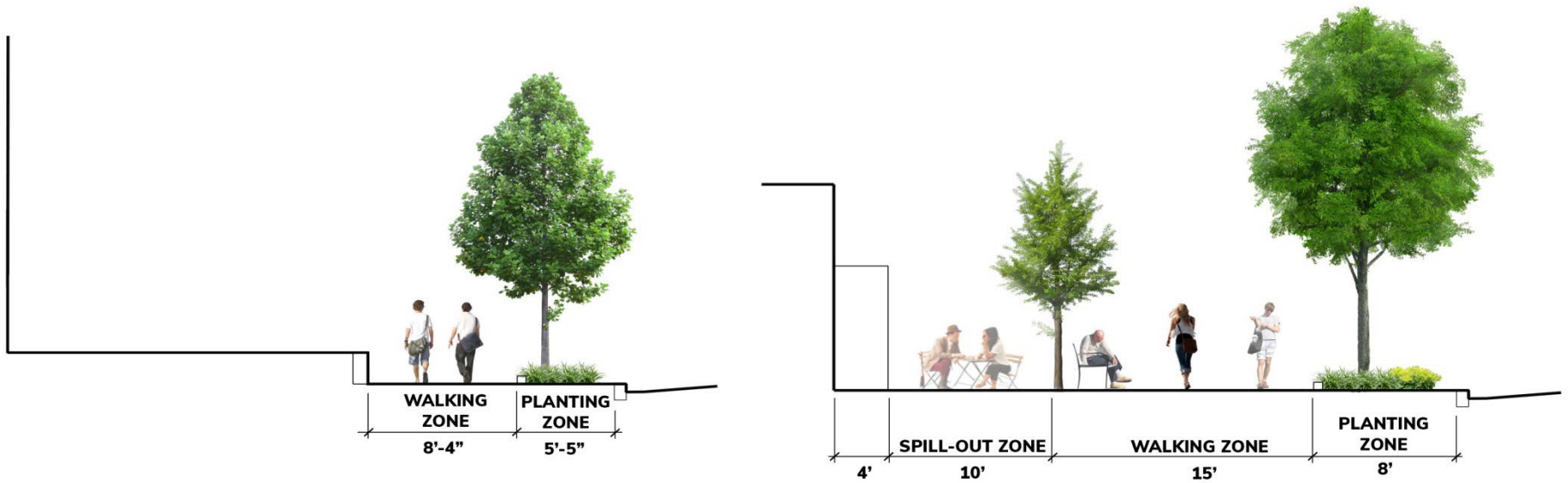

Public Realm near Fire Station



Public Realm near Fire Station



Public Realm at the Porter Street and Quebec Street Intersection



Public Realm at the Porter Street and Quebec Street Intersection

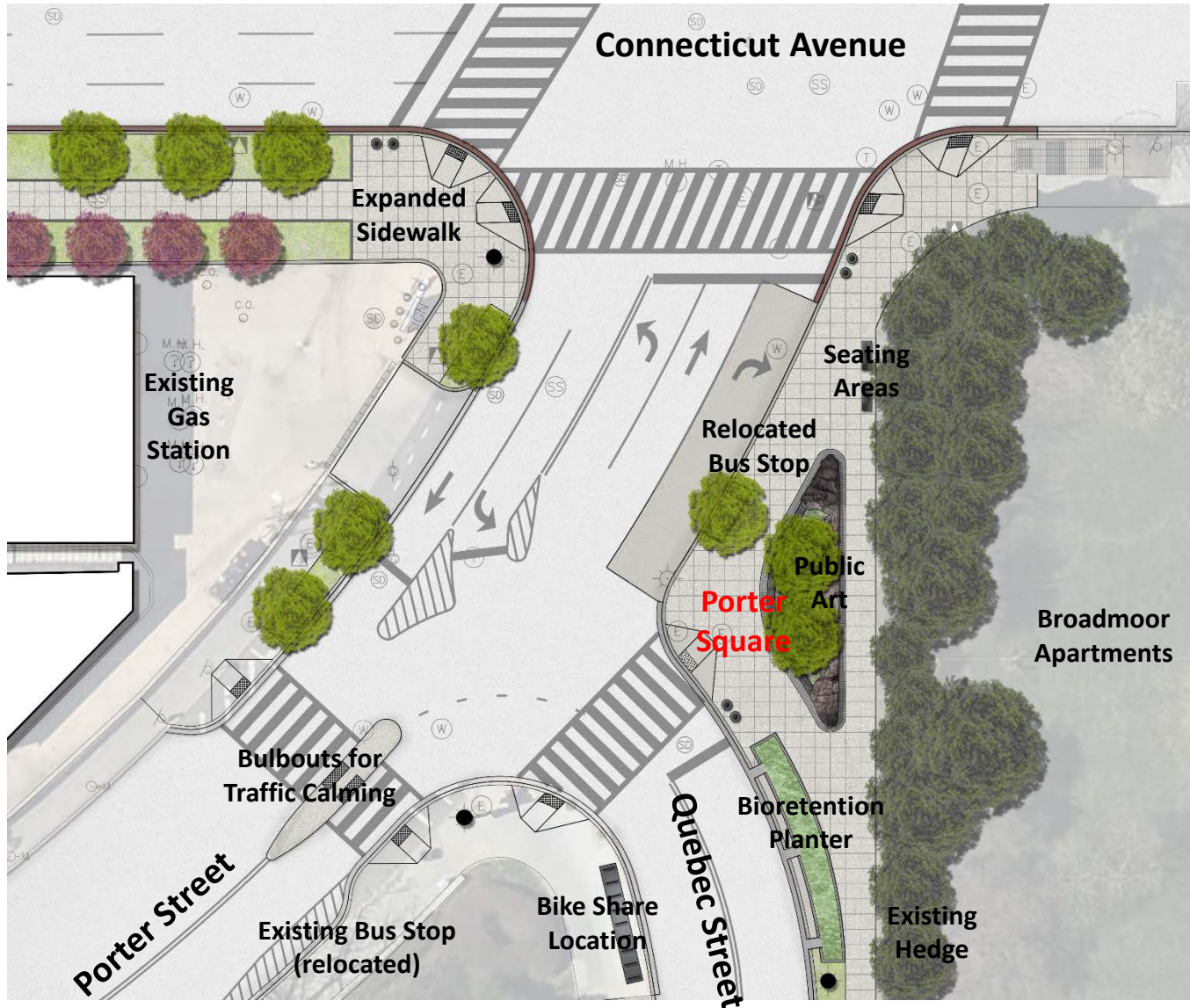

Public Realm at the Porter Street and Quebec Street Intersection



Public Realm at the Porter Street and Quebec Street Intersection



Limits of Green Infrastructure in Project Area

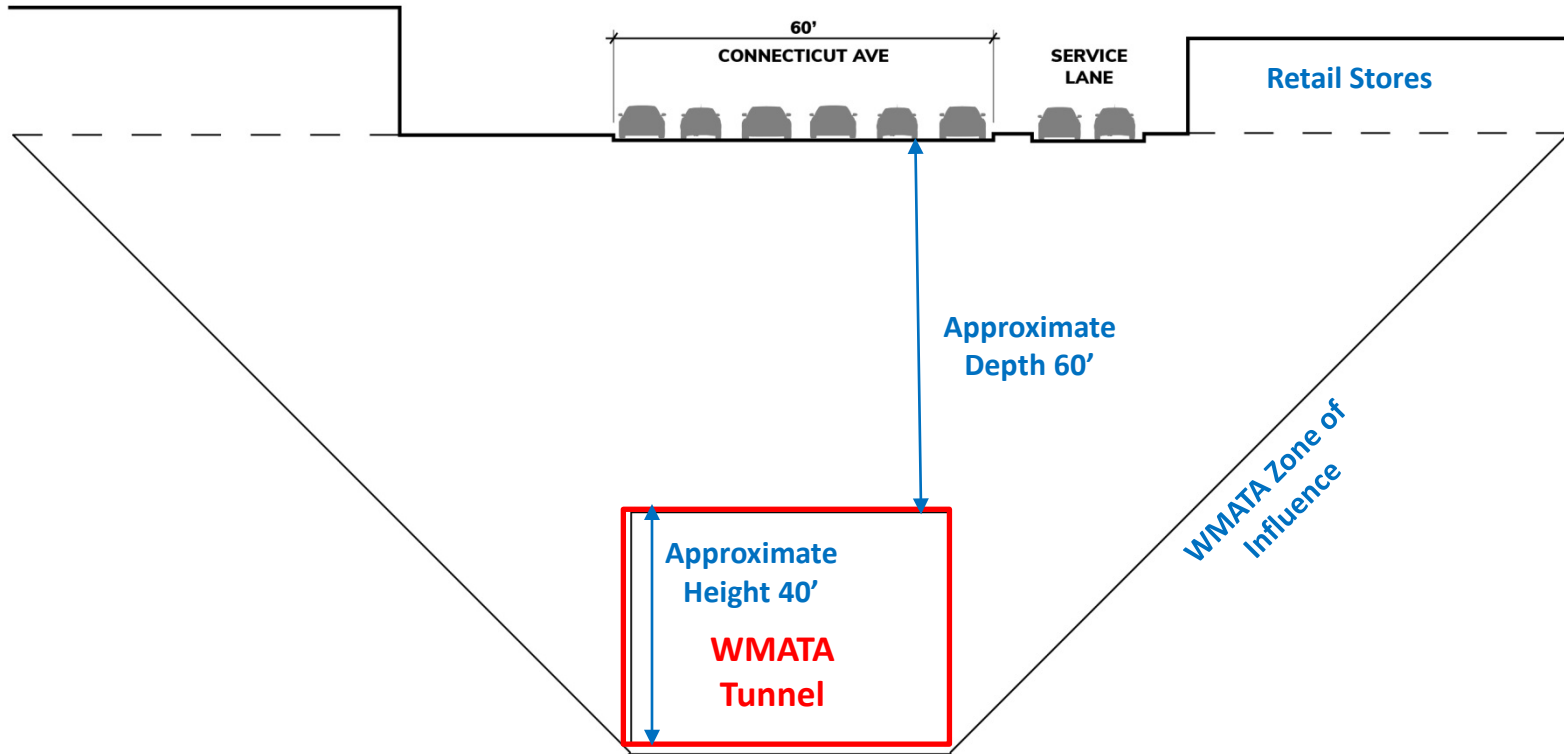

Site Furnishing

Behavior Indicators



3' Granite Bollard



Segmented Granite Curb
12" wide x 6" high x variable length

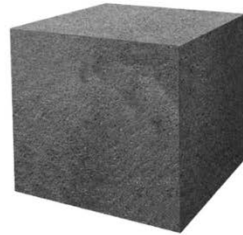

Granite Stone
Seating Blocks



Streetscape
Planter

Bike Shelter near Metro Escalator

