

# Rehabilitation of the 16<sup>th</sup> St. NW Bridge Over Piney Branch Parkway Project

Welcome! Thank you for joining us.  
This meeting will begin soon...

Virtual Public Kick-off Meeting  
April 20, 2022

# Welcome to our virtual public meeting!

To begin, we will review some basic controls to help you participate on this platform.

**Please Note:** This is an open meeting and as required by DC Code 2-578, this meeting is being recorded, and the recording will be made available to the public.

- The video file (with both audio and video) will be shared on the project team's website and DDOT's YouTube Channel ([YouTube.com/DDOTVideos](https://www.youtube.com/DDOTVideos)) within 7 days after the meeting has ended.
- This meeting is being livestreamed to DDOT's Facebook page: [Facebook.com/DDOTDC](https://www.facebook.com/DDOTDC)
- If you do not wish to have your voice recorded, please do not ask to speak. You may enter any questions or comments in the Q&A which we will review shortly.

If you need technical support during this meeting, please call 202-309-3491

# Using Webex – Audio & Video

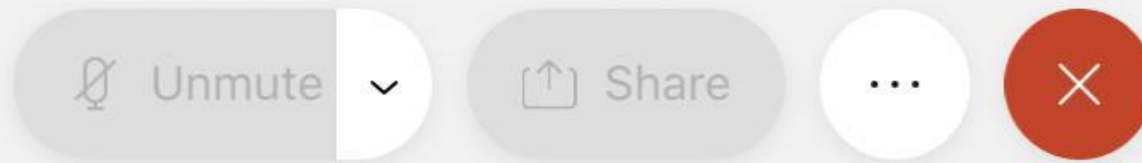

## Audio/Muting

- Everyone is on mute. You cannot unmute yourself. We can unmute you during the Q&A and Comment period. This helps ensure the meeting runs smoothly and there are no auditory disruptions during the presentation.
- To request to speak, you will need to use the **Raise Hand** feature, which we will cover shortly.

## Video

- Your video camera is off by default and you will not be able to share video.

# Using Webex – Raise Hand

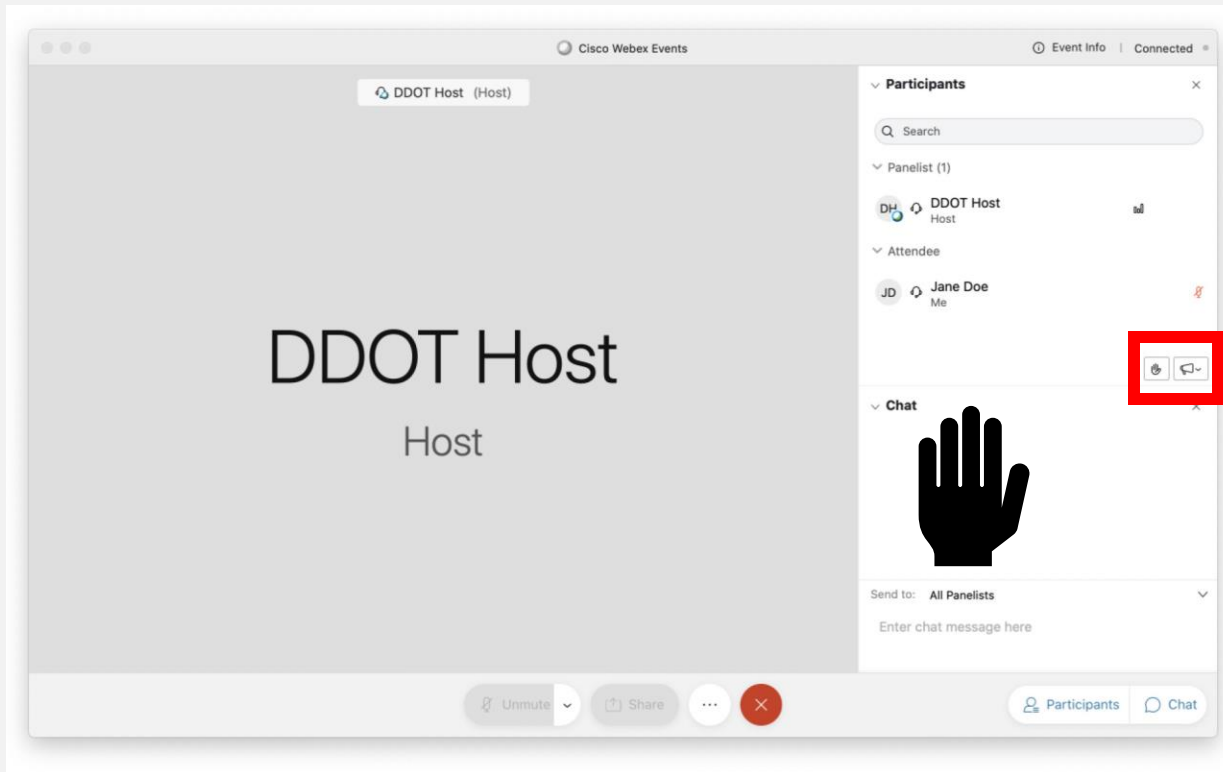

If you have a question or comment that you would like to speak up about, please **raise your hand**. This indicates to the Project Team that you would like to speak.

To virtually raise your hand:

- Click **“Participants”** on the bottom right of the Webex window.
- A new panel or window will appear. Near the bottom of the panel/window, there will be a small hand icon. **Click the hand icon** to Raise your Hand.

If you joined via browser or mobile app, click the 3 dot (...) icon and select Raise Hand.

If you dialed in by phone, **dial \*3** to use the Raise Hand function.

# Agenda



- Introduction
- Opening Remarks
- Welcome Community Partners
- Project Overview
- Project Objective
- Maintenance of Traffic
- Q & A
- Title VI Survey Questionnaire
- Stay Connected

# Introduction

## DDOT

- **Zahra Dorriz, PE**
  - Program Manager IPMD Team 2, Wards 3 &4
- **Omid Ghaemi, PE**
  - Project Manager
- **Nannette Bowles, CPM, MBA**
  - Resident Engineer
- **Alberta Paul**
  - DDOT/IPMD Communication Specialist City Wide
- **Christian Piñeiro**
  - DDOT Ward 3 Community Engagement Specialist



# Introduction



## Construction Management Team

- **Rob Lancaster, PE**
  - Senior Project Lead, BREE & Associates
- **Vincent Kumordzie, PE**
  - Resident Engineer, CKI & Associates, Inc.
- **Andrew Li, PE**
  - Construction Manager, Gannett Fleming
- **Jam Kendrick**
  - Public Outreach, TB&A

# Community Partners



U.S. Department  
of Transportation  
**Federal Highway  
Administration**





# Project Overview

## **Project Purpose and need:**

- The purpose of this project is to rehabilitate the bridge based on the recommendations of the “2013 Bridge Inspection report”

## **Background:**

- Single span and closed spandrel deck arch bridge
- Dual arches connected with steel beams
- Built in 1906 & 1910 and rehabilitated in 1992
- Historic Bridge - First parabolic concrete arch bridge in US
- It carries 5 lanes – 2NB, 2SB, & 1RV.

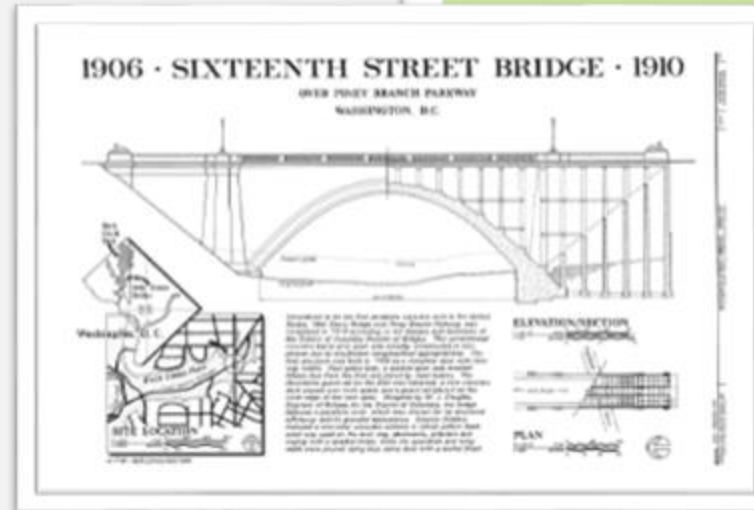

# Project Objective

## ■ Safety Improvements

- Replace pedestrian fence
- Abutment slope improvement
- Replace NW approach guardrail
- Upgrade bridge lighting
- Traffic signal upgrades

## ■ Bridge Rehab Improvements

- Concrete repairs (including deck replacement)
- Sculpture restoration
- Addition of Stormwater Management (SWM) biofiltration planters



# Fencing

**Existing Fence** | Installed prior to 1992 rehabilitation | Existing Fence Height 8'-1/2"



# Fencing

## Recommended Alternative

- Proposed 9'-6" Height is DDOT Standard for Safety



Aerial View



Driver View



# Bridge Lighting & Traffic Signal Upgrades



1906 – 1910

1910 – 1992

1992 – Present

## Bridge Lighting

- Existing lighting was installed after 1992 rehabilitation
- Current rehabilitation include sandblasting, cleaning, and repainting fixture.
- Conversion to LED includes a retrofit kit to be installed within the existing globes.

## Traffic Signal Upgrades

- 16th Street, Shepherd Street and Arkansas Ave., NW

# Slope Stabilization

## Existing Slope Condition

- Existing slopes have some vegetation growth and exposed tree roots and areas show signs of erosion.



# Slope Stabilization

## Proposed Solution

- Vegetated Cellular Confinement: **EviroGrid**

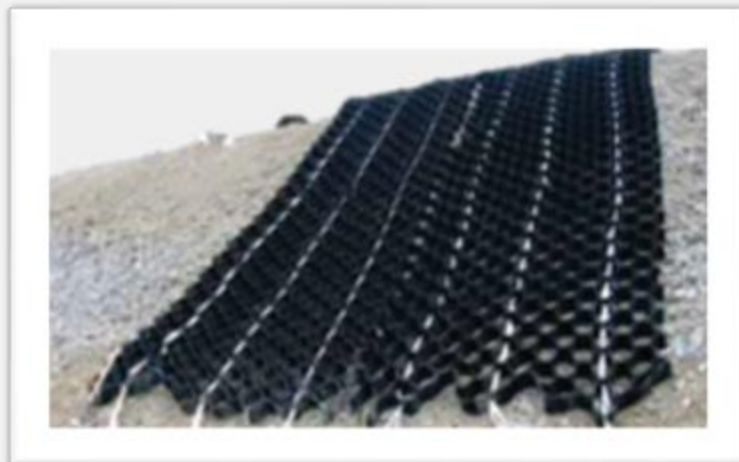
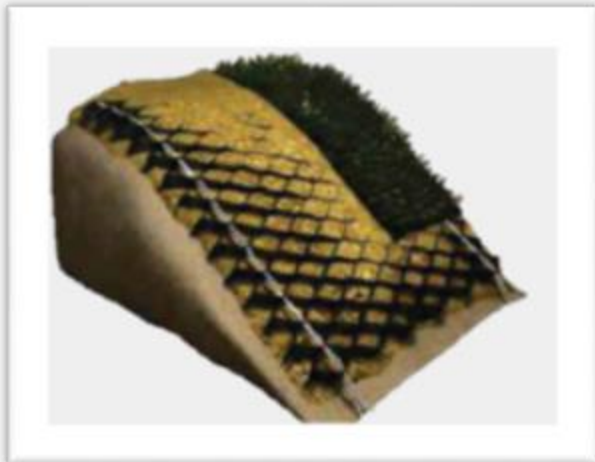

# Guardrail



Existing Timber  
Guardrail



# Guardrail-replacement alternatives

## FLH Steel-Backed Timber Guardrail



# Concrete Repairs

Example railing post and light pole base defects



# Concrete Repairs

## Example baluster defects



# Concrete Repairs

- Concrete repairs to bridge exterior and interior including spandrel walls, arches, columns/struts, deck, curb, railing, and statue pedestals
- Railing coping, balusters, and pedestals to be replaced and repointed as needed.
- Specific contract requirements to be followed for:
  - Cleaning of bridge surfaces
  - Matching of color, aggregate shape and texture of repairs to historic concrete
  - Mockups of cleaning, concrete removal, patch/crack repairs, and repointing



# Concrete Repairs – Bridge Exterior

## Example spandrel wall repairs

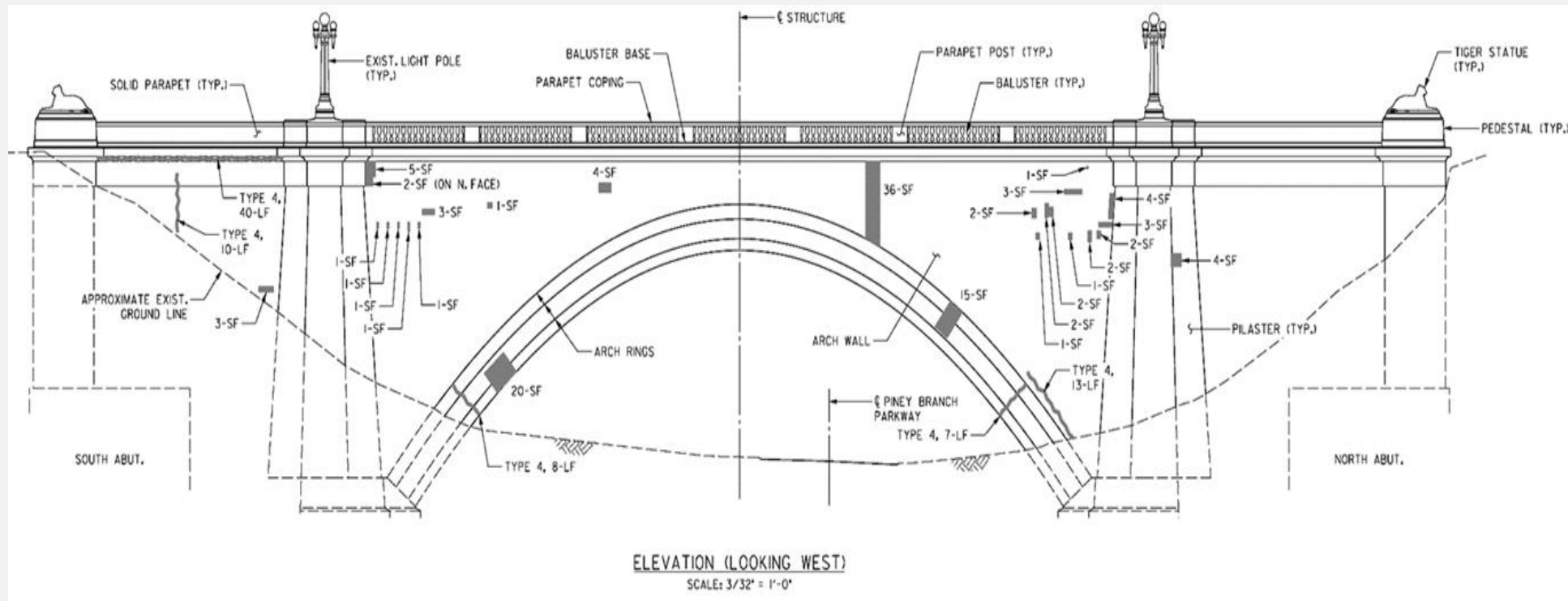

# Sculpture Restoration

- Cleaning of sculptures
- Application of protective wax coating
- Methods and procedures for cleaning and waxing provided in the condition assessment for the bronze tiger's report

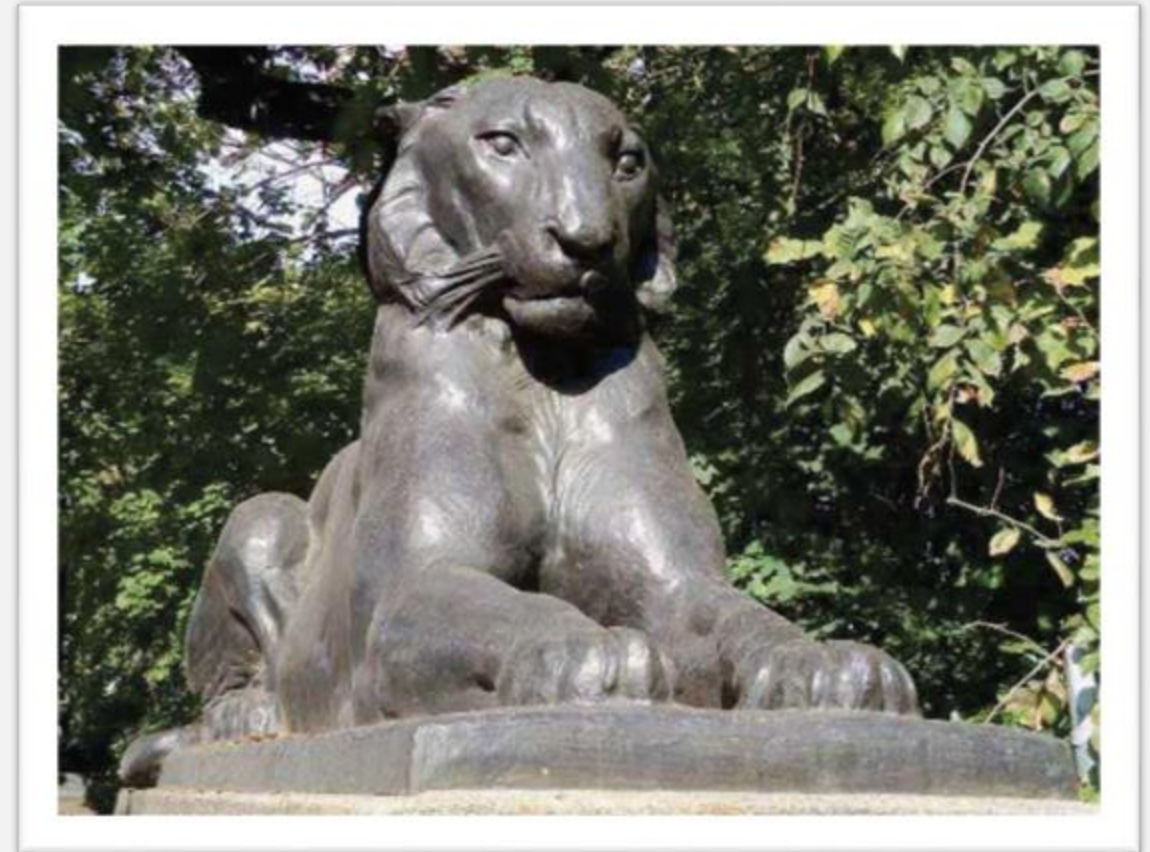

# Proposed Addition of Stormwater Management (SWM) Bioretention Planters

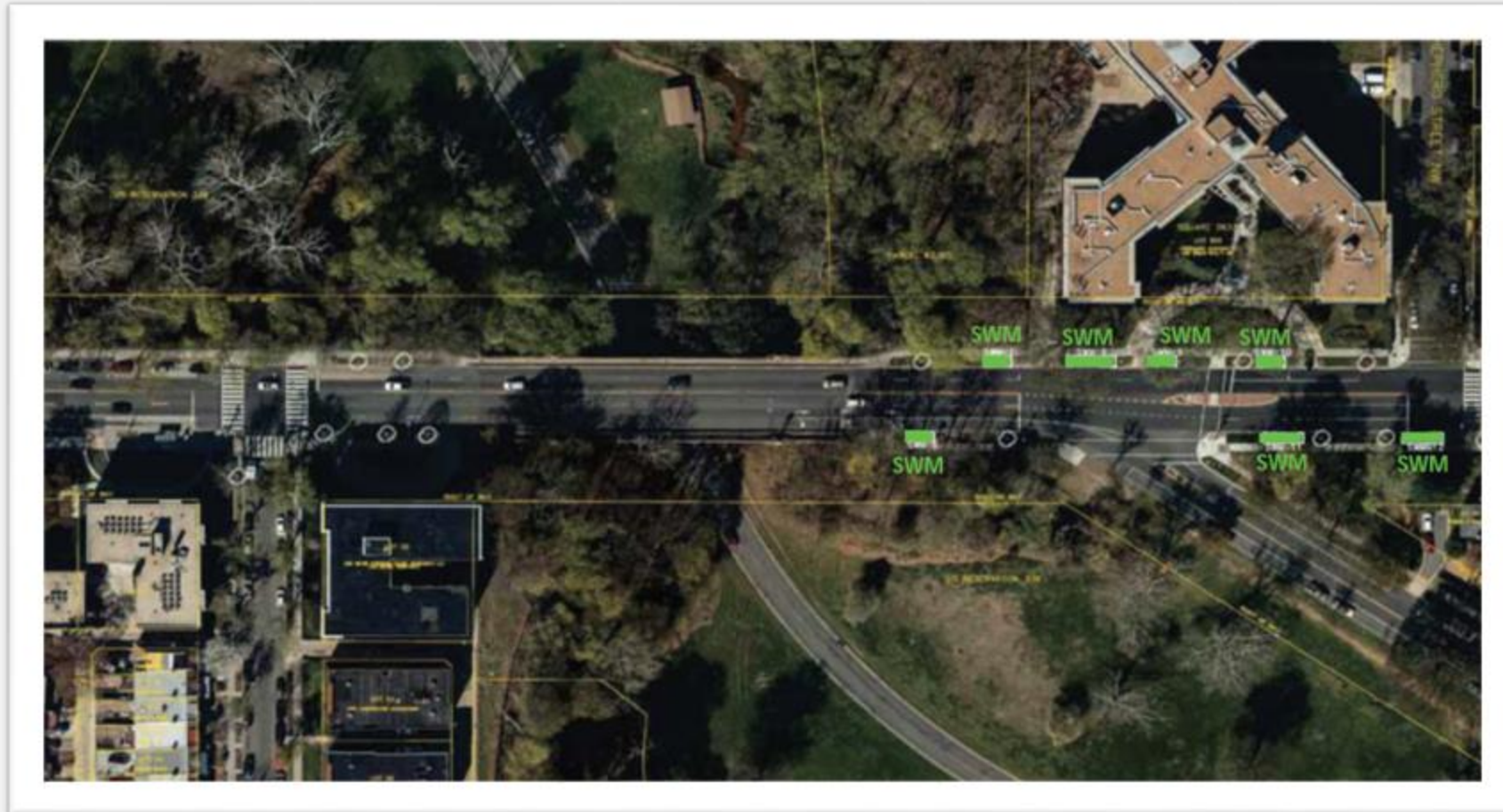

# Reinforced Concrete Deck Restoration with Latex Modified Concrete



- Remove existing Hot Mix Asphalt (HMA) overlay & portion of existing lightweight concrete fill above deck and replace with new lightweight concrete fill & latex-modified concrete overlay to match proposed finished roadway elevations.
- Remove and replace gutter block to match proposed finished roadway elevations.



# Maintenance of Traffic

## 16th Street NW

- Construction will require full-time lane closures on the bridge
- Two lanes closed at a time (4 Construction Stages)
  - Morning Peak: Two SB Lanes, One NB Lane
  - All Other Times: Two NB Lanes, One SB Lane
  - Pedestrian detours during Stages 1 and 2

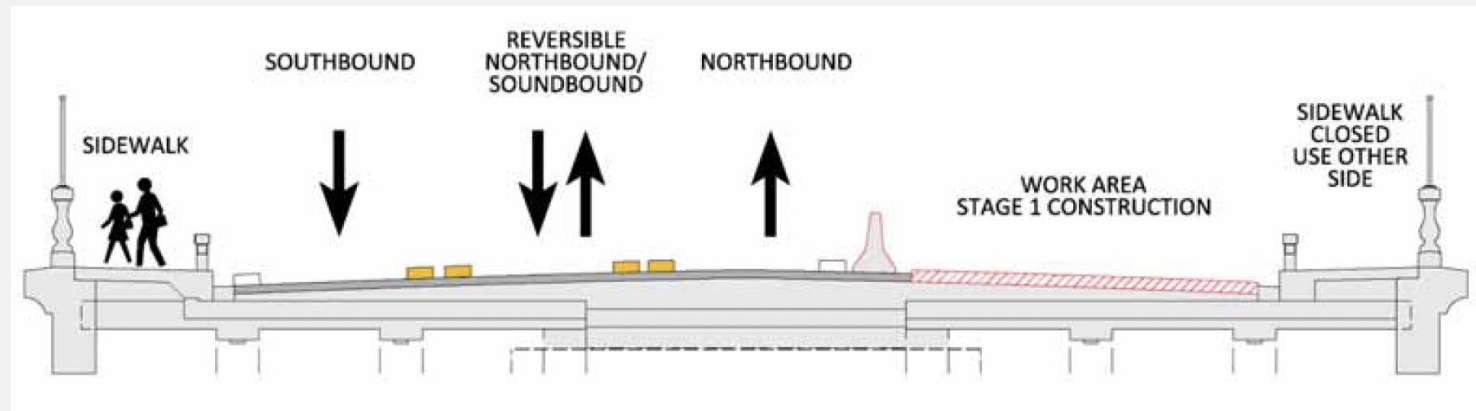

# Maintenance of Traffic

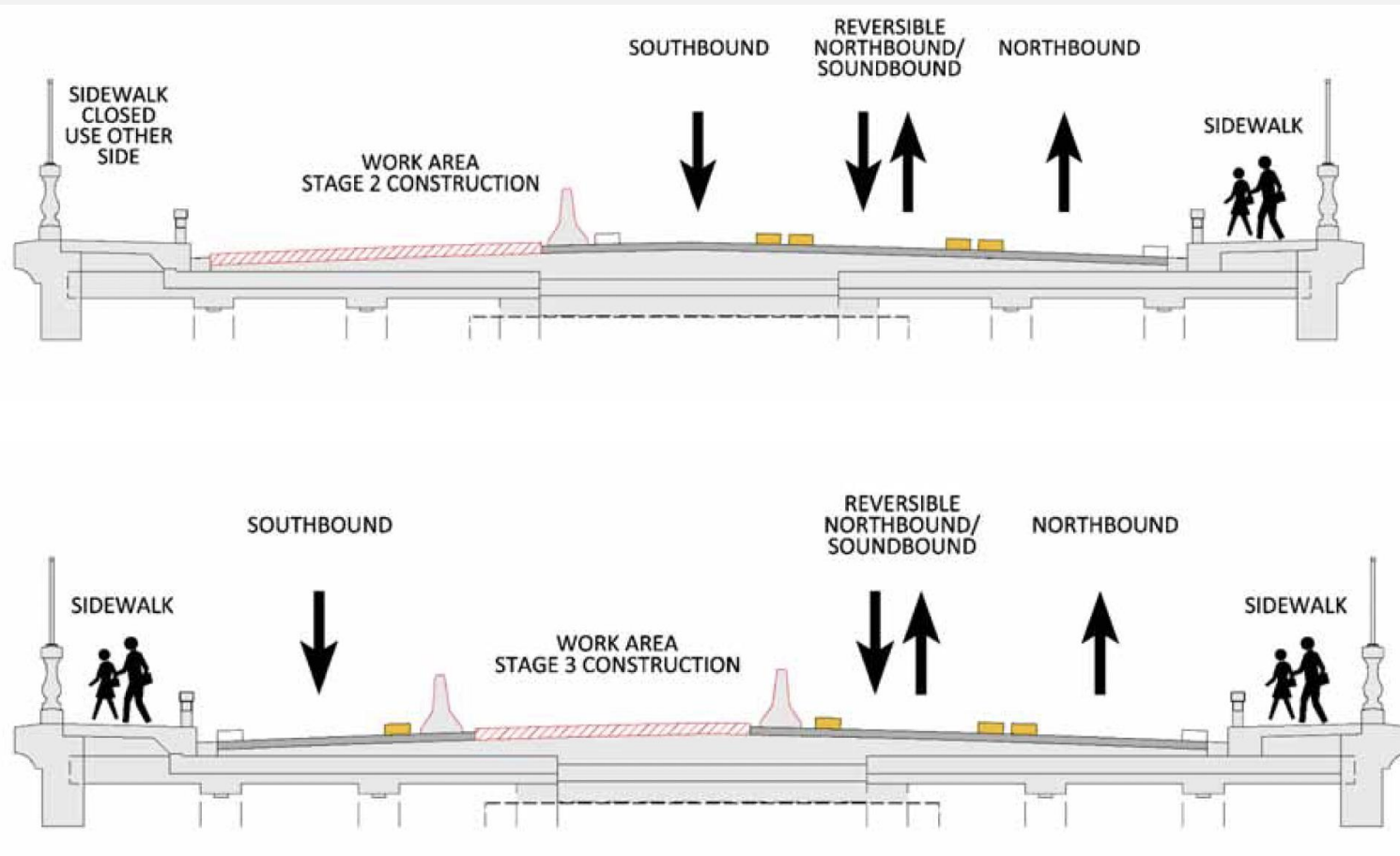

# Detours and Closures

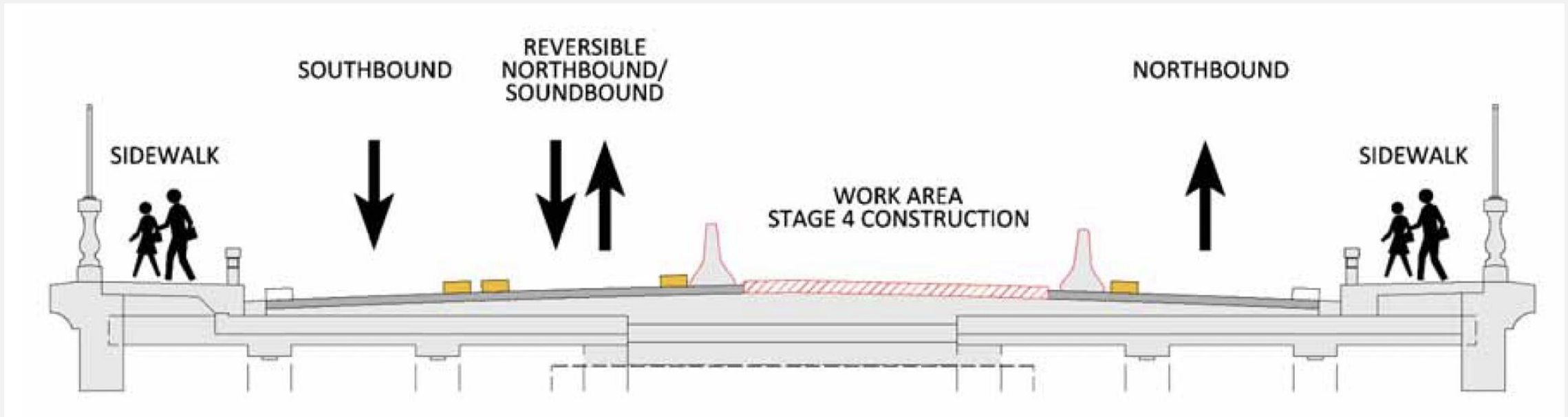

# Maintenance of Traffic

## 16th Street NW

- Alternate Routes:
  - Georgia Avenue
  - Connecticut Avenue
    - Via Military Road/Nebraska Avenue
  - Beach Drive
    - Lower Section of Beach Drive
- Construction will be complete before this construction begins

## Piney Branch Parkway

- Off-Peak / Temporary lane closures along Piney Branch
- Single lane closures with flagging operations
- Work hours limited to minimize traffic impacts

# Construction Timeline

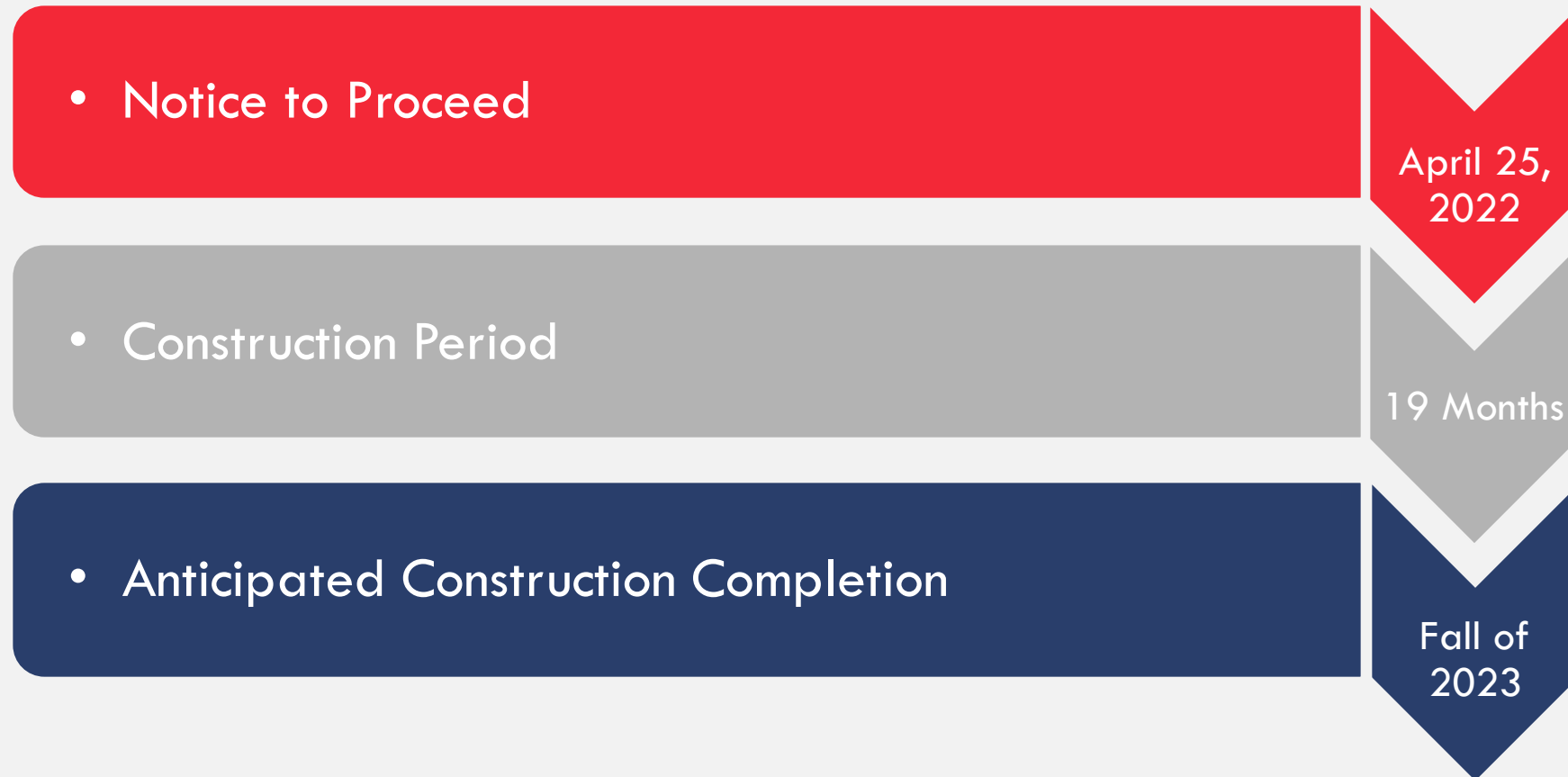

# Using Webex – Q&A

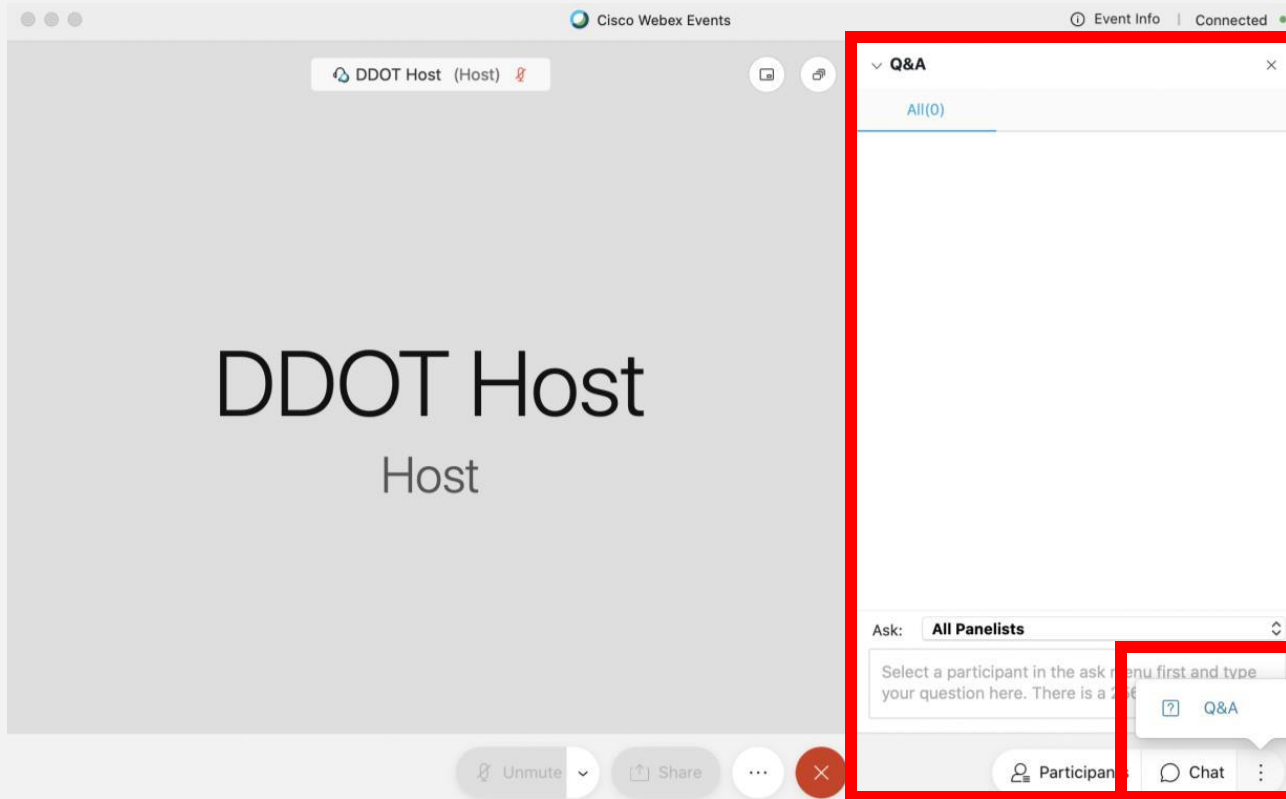

If you have a question during the presentation, send it via the Q&A feature.

**Note:** If Q&A is enabled, the Q&A panel will be open by default when you join the Event.

To Send a Question:

- Click the **“three dot icon”** in the bottom right side of the Webex window and select **Q&A**.
- A new panel or window will appear. In the **“Ask”** field, select **All Panelists**.
- Click the text box to type your question and press the Enter key to send it.

If you joined via Browser or Mobile App, click the Question Mark icon to access the Q&A to ask a question.

If you dialed in by phone, **dial \*3** to use the Raise Hand function. This indicates to the Project Team that you would like to speak and ask a question.

# Title VI - [rebrand.ly/16thStBridgeoverPineyBranch-Comments](https://rebrand.ly/16thStBridgeoverPineyBranch-Comments)



**Title VI Public Involvement Questionnaire**

The District Department of Transportation is committed to providing all citizens, regardless of race, color, age, gender, or national origin, the opportunity to participate in and respond to transportation plans, programs, and activities that may affect their community. To help us make sure we are reaching our goal and maintaining compliance with Title VI of the Civil Rights Act of 1964 and all relevant federal and local nondiscrimination laws, we ask that you voluntarily complete the following information. DDOT's Title VI Coordinator will handle the information you provide with confidentiality. For more information regarding DDOT's Title VI Program, please contact DDOT's Transportation Equity and Inclusion Division at 202.671.2700 or [ddot@ddc.gov](mailto:ddot@ddc.gov).

[Sign in to Google to save your progress. Learn more](#)

Project/Meeting Name & Date

Rehabilitation of 16th St. Bridge over Piney Branch Pkwy, NW Project, April 20, 2022

Was this meeting held at a convenient time?

Yes

No

[Next](#) [Clear form](#)

- As a recipient of Federal assistance, DDOT must ensure that all of its programs, activities and public meetings are conducted in compliance with Title VI of the Civil Rights Act of 1964. This Act ensures nondiscrimination based on race, color or national origin. The Title VI Public Meeting Participant Questionnaire is used to help DDOT ensure that we are informing the public and conducting our meetings in a nondiscriminatory manner, in compliance with Title VI.
- Project comments and/or concerns may also be submitted through this form. We appreciate anyone who is willing to complete the form.
- Thank you for your participation.
- [rebrand.ly/16thStBridgeoverPineyBranch-Comments](https://rebrand.ly/16thStBridgeoverPineyBranch-Comments)



# Stay Connected

## Contact Information

*Project Community Outreach Manager:*

Jam Kendrick, [jam@tbaconnects.com](mailto:jam@tbaconnects.com)

*DDOT Community Engagement Specialist*

Christian Piñeiro, [christian.pineiro@dc.gov](mailto:christian.pineiro@dc.gov)

*DDOT Resident Engineer:*

Nannette Bowles, [nannette.bowles@dc.gov](mailto:nannette.bowles@dc.gov)







---

# District Department of Transportation

**250 M St SE | Washington, DC 20003 | 202.673.6813**